

RediPower

Industrial Tools



Ready When You Are

RediPower

Ready when you are

Readily available, easy to use, durable and ready to respond to your needs. These features have contributed to the success of **RediPower** since it came into existence in the mid nineties. From then, our unwavering commitment to our clients needs, together with our attention to quality, make it possible for **RediPower** to offer an ever increasing number of effective solutions for general duty and maintenance applications.

This results today, in the existence of more than **120 products** including impact wrenches, ratchet wrenches, screwdrivers, sanders, grinders, drills, hammers, needle scalars, belt sanders and various accessories. In other words, the widest range of industrial general duty tools on the market. This demonstrates the creativity we put into meeting your expectations: our tools are always ready when you are.



www.cp.com



Content



Impact & Ratchet Wrenches

Page 2

ACCESSORIES PAGE 9



Screwdrivers

Page 10

ACCESSORIES PAGE 15



Drills

Page 16

ACCESSORIES PAGE 21



Grinders

Page 22

ACCESSORIES PAGES 28-29



Sanders

Page 30

ACCESSORIES PAGES 34-35



Hammers

Page 36

ACCESSORIES PAGES 40-41



Speciality tools

Page 42

Air line Network

Page 45

Tune-up kits & Repair kits Index - Safety Instructions

Page 46





RediPower



Impact & Ratchet wrenches

Different types of joints

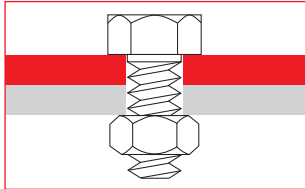

Hard joint:
metal on metal

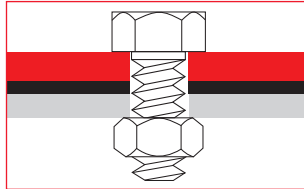

Soft joint:
joint between 2 metal pieces

This is why we propose several types of clutch

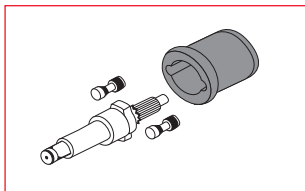

Pin clutch:
Excellent on hard joints with a good power/weight ratio.

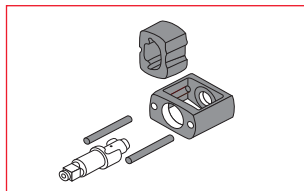

Single dog clutch:
For soft and hard joints. High power/weight ratio.

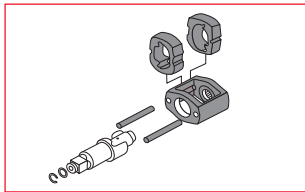

Twin dog clutch:
All round clutch with a high ultimate torque and high power/weight ratio.

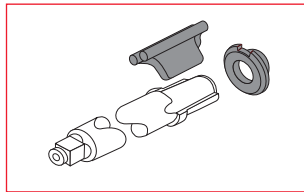

Rocking dog clutch:
Good on very soft joints providing high speed rundown.

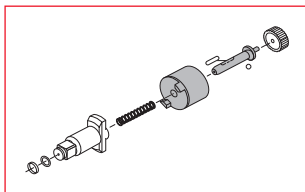

2 Jaw clutch:
Good on soft or hard joints with high ultimate torques.

Clutch Options: Weight/ Power ratio			
Type of Clutches:	Hard	Soft	Very soft
Pin clutch	✓	✓	✓
Single dog clutch	✓	✓	✓
Twin dog clutch	✓	✓	✓
Rocking dog clutch	✓	✓	✓
2 Jaw clutch	✓	✓	✓

Ultimate ✓ Very good ✓ Good ✓

A wide selection of retainers provides versatility for every type of application - all with power, speed and comfort.

Finally, your toughest jobs have met their match.



Pin Retainer
for infrequent socket change



Hole
for pin o-ring type retention



Friction Ring
for rapid socket change



Quick Change
for screwdriver bits or torsion bars



Which tool to choose?

Impact wrenches

An impact wrench delivers a series of rotary blows to a fastener, producing torque. The advantage of impact wrenches is the high power-to-weight ratio, fast rundown, and limited torque reaction to the operator.

Ratchet wrenches

For fastening applications in tight and difficult-to-access areas, RediPower offers you a wide range of ratchet wrenches with various square drive sizes (1/4", 3/8", 1/2") and torque from 7 to 122Nm (5 to 90ft.lb).

To make the best assembly, you can choose an impact or a ratchet wrench.

As a guide, use the table below. This will assist you in making the correct choice of tool for your application.

In case of use:	Impact Wrenches	Ratchet Wrenches
Tight access	✓	✓
Standard fastening	✓	✓
Break type fastening	✓	✓
Locking screw	✓	✓
Unlocking screw	✓	✓
Socket type "impact"	✓	✓
Standard socket	✓	✓
Fast forward and reverse fastening	✓	✓
Slow forward and reverse fastening	✓	✓

Ultimate ✓ Not suitable ✓ Good ✓

Impact wrenches - 3/8"



RP9521

Energy efficient motor

FEATURES

- Rocking dog clutch
- Friction ring socket retainer
- Built-in power regulator
- Ergonomic handle

BENEFITS

- Great tool for soft joints
- Improves productivity and quality
- Operator comfort
- Compact for easy access

RP9523



Same features as RP9521 with Pin socket retainer



RP9522

Versatility tool

FEATURES

- Rocking dog clutch
- Friction ring socket retainer
- Built-in power regulator
- Butterfly start/reverse trigger
- 360° air inlet swivel connector

BENEFITS

- Great tool for soft joints
- Quick direction change
- Compact for easy access



RP9524

High torque in small package

FEATURES

- Pin clutch
- Friction ring socket retainer
- Through handle air exhaust
- Compact & ergonomic

BENEFITS

- Clutch delivers smooth operation & extends durability
- One hand push button forward/reverse
- Exhaust is directed away from work piece



RP9525

High torque in small package

FEATURES

- Pin clutch
- Pin socket retainer
- Built in power regulator
- Through handle air exhaust
- Compact & ergonomic

BENEFITS

- Versatile & comfortable
- Quick torque adjustment
- Positive socket retention

See accessories on page 9

MODEL	PART NUMBER	SQUARE DRIVE	FREE SPEED	WORKING TORQUE		MAXIMUM TORQUE		AIR CONSUMPTION		OVERALL LENGTH		NET WEIGHT		NOISE LEVEL	SOUND POWER	VIBRATION	AIR INLET
		in.	rpm	Nm	ft. lb	Nm	ft. lb	l/s	cfm	mm	in.	kg	lb	dB(A)	dB(A)	m/s ²	NPTF
RP9521	615 190 9521	3/8	11,000	6.8-70	5-50	122	90	4.7	10	146	5.75	1.2	2.6	84	95	4.9	1/4"
RP9522	615 190 9522	3/8	9,500	6.8-70	5-50	122	90	4.7	10	146	5.75	0.9	2.0	86	97	2.6	1/4"
RP9523	615 190 9523	3/8	11,000	6.8-70	5-50	122	90	4.7	10	146	5.75	1.2	2.6	84	95	4.9	1/4"
RP9524	615 190 9524	3/8	8,500	27-217	20-160	272	200	5.7	12	152	6.0	1.4	3.1	94	105	<2.5	1/4"
RP9525	615 190 9525	3/8	8,500	27-217	20-160	272	200	5.7	12	152	6.0	1.4	3.1	94	105	<2.5	1/4"

@90 PSI(@6.3 Bar) - Listed specifications are for reference only. Please check documents in each tool.



Impact wrenches - 1/2"

RediPower

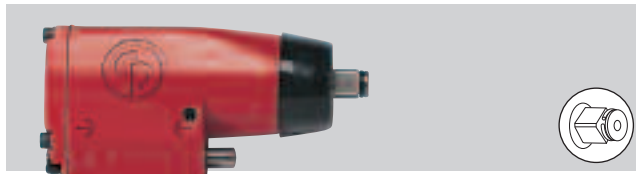

RP9526

Very compact 1/2" tool

FEATURES

- Pin clutch
- Friction ring socket retainer
- Built in power regulator
- Through handle air exhaust
- Compact & ergonomic
- Forward position : 4 power settings
- Maximum reverse power

BENEFITS

- High torque in a compact tool
- One hand push button forward/reverse

RP9527



Same features as RP9526 with Pin socket retainer



RP9540

High torque/size ratio

FEATURES

- Pin clutch
- Friction ring socket retainer
- Through handle air exhaust
- Compact & ergonomic
- Forward position : 4 power settings
- Maximum reverse power

BENEFITS

- High torque/size ratio
- One hand push button forward/reverse



**RP9550
RP9552
Kits**

Same features as RP9540 in kits with Imperial (IKIT) and Metric (MKIT) sockets sizes
See details on page 9



RP9541

Withstanding rough use

FEATURES

- Pin clutch in oil bath
- Friction ring socket retainer
- Steel clutch housing

BENEFITS

- Ideal for fast rundown with high torque
- Easy maintenance
- Durability

RP9542



Same features as RP9541 with Pin socket retainer

RP9543



Same features as RP9541 with Quick change chuck

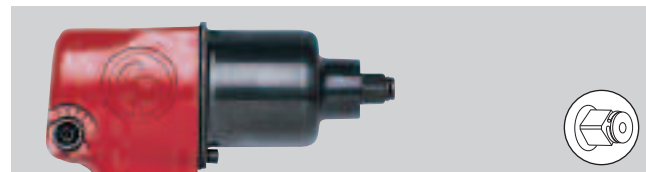

RP9545

Durability & economy

FEATURES

- Pin clutch
- Friction ring socket retainer
- High reverse torque
- High torque/air consumption ratio
- Ergonomic handle

BENEFITS

- Ideal for rework operations
- Operator comfort
- Quick torque adjustment

See accessories on page 9

MODEL	PART NUMBER	SQUARE DRIVE	FREE SPEED	WORKING TORQUE		MAXIMUM TORQUE		AIR CONSUMPTION		OVERALL LENGTH		NET WEIGHT		NOISE LEVEL	SOUND POWER	VIBRATION	AIR INLET
				Nm	ft lb	Nm	ft lb	l/s	cfm	mm	in.	kg	lb				
RP9526	615 190 9526	1/2	8,500	27-217	20-160	272	200	5.7	12	152	6.0	1.4	3.1	94	105	<2.5	1/4"
RP9527	615 190 9527	1/2	8,500	27-217	20-160	272	200	5.7	12	152	6.0	1.4	3.1	94	105	<2.5	1/4"
RP9540	615 190 9540	1/2	8,400	34-420	25-310	576	425	7.1	15	191	7.5	2.3	5.1	94	105	<2.5	1/4"
RP9541	615 190 9541	1/2	8,900	34-434	25-320	603	445	6.6	14	168	6.6	2.5	5.5	89	100	2.7	1/4"
RP9542	615 190 9542	1/2	8,900	34-434	25-320	603	445	6.6	14	168	6.6	2.5	5.5	89	100	2.7	1/4"
RP9543	615 190 9543	7/16 hex	8,900	34-434	25-320	603	445	6.6	14	199	7.8	2.6	5.8	89	100	2.7	1/4"
RP9545	615 190 9545	1/2	6,900	34-542	25-400	746	550	9.0	19	180	7.1	2.5	5.6	96	107	4.0	1/4"
RP9550 IKIT	615 190 9550	1/2	8,400	34-420	25-310	576	425	7.1	15	191	7.5	2.3	5.1	94	105	<2.5	1/4"
RP9552 MKIT	615 190 9552	1/2	8,400	34-420	25-310	576	425	7.1	15	191	7.5	2.3	5.1	94	105	<2.5	1/4"

@90 PSI(@6.3 Bar) - Listed specifications are for reference only. Please check documents in each tool.



Impact wrenches - 1/2" and 3/4"



RP9546



Heavy duty & comfort



FEATURES

- Pin clutch
- Friction ring socket retainer
- Steel clutch housing
- Ergonomic grip
- Forward position : 4 power settings
- Maximum reverse power

BENEFITS

- Good for soft & hard joints
- Withstands rough use
- Operator comfort
- Quick torque adjustment

RP9546 Kits

Same features as RP9546 in kits with Imperial (IKIT) and Metric (MKIT) sockets sizes

See details on page 9



RP9549



Comfort and flexibility

FEATURES

- Single dog clutch
- Friction ring socket retainer
- Steel clutch housing
- Ergonomic grip

BENEFITS

- Good for soft & hard joints
- Withstands rough use
- Versatility & durability

RP9547



Same features as RP9549 with Hole socket retainer



RP9560



Power & durability

FEATURES

- Pin clutch
- Friction ring socket retainer
- High power to weight ratio
- Forward position: 4 power settings
- Maximum reverse power

BENEFITS

- Good for hard joints
- Operator comfort

RP9551 RP9553 Kits

Same features as RP9560 in Kits with Imperial (IKIT) and Metric (MKIT) sockets sizes

See details on page 9



RP9561



Strong & durable

FEATURES

- Pin clutch in oil bath
- Hole type socket retainer
- Steel clutch housing
- Built-in power regulator

BENEFITS

- Withstanding rough use
- Ideal for fast rundown with high torque
- Easy for maintenance

See accessories on page 9

MODEL	PART NUMBER	SQUARE DRIVE	FREE SPEED	WORKING TORQUE		MAXIMUM TORQUE		AIR CONSUMPTION		OVERALL LENGTH		NET WEIGHT		NOISE LEVEL	SOUND POWER	VIBRATION	AIR INLET
				Nm	ft lb	Nm	ft lb	l/s	cfm	mm	in.	kg	lb				
RP9546	615 190 9546	1/2	6,400	68-610	50-450	827	625	2.6	5.5	178	7.0	2.49	5.5	95	106	4.9	1/4"
RP9546 MKIT	615 190 0546	1/2	6,400	68-610	50-450	827	625	2.6	5.5	178	7.0	2.49	5.5	95	106	4.9	1/4"
RP9546 IKIT	615 190 8546	1/2	6,400	68-610	50-450	827	625	2.6	5.5	178	7.0	2.49	5.5	95	106	4.9	1/4"
RP9547	615 190 9547	3/4	3,900	271-1017	200-750	1559	1150	18.4	39	226	8.9	5.75	12.6	97	108	8.0	3/8"
RP9549	615 190 9549	3/4	3,900	271-1017	200-750	1559	1150	18.4	39	226	8.9	5.75	12.6	97	108	8.0	3/8"
RP9551 IKIT	615 190 9551	3/4	4,200	200-950	150-700	1360	1000	11.3	24	244	9.6	4.80	10.5	99	110	4.9	3/8"
RP9553 MKIT	615 190 9553	3/4	4,200	200-950	150-700	1360	1000	11.3	24	244	9.6	4.80	10.5	99	110	4.9	3/8"
RP9560	615 190 9560	3/4	4,200	200-950	150-700	1360	1000	11.3	24	244	9.6	4.80	10.5	99	110	4.9	3/8"
RP9561	615 190 9561	3/4	5,500	102-680	75-500	1020	750	14.1	30	216	8.5	4.80	10.5	100	111	5.1	3/8"

@90 PSI(@6.3 Bar) - Listed specifications are for reference only. Please check documents in each tool.

Impact wrenches - 1"

RediPower

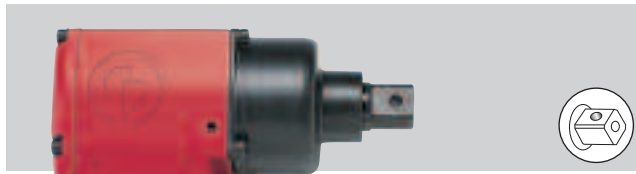

RP9548

Compact tool

FEATURES

- Single dog clutch
- Hole type socket retainer
- Steel clutch housing
- Ergonomic grip

BENEFITS

- Good for soft joints
- Withstands rugged use
- Compact tool



RP9597

Power & easy handling

FEATURES

- 2 Jaw clutch in oil bath
- Hole type socket retainer
- Steel clutch housing
- 3 pieces construction
- High torque

BENEFITS

- Good for both soft & hard joints
- Withstands rugged use
- Adjustable dead handle for operator comfort



RP9582

Safe & easy to handle

FEATURES

- Rocking dog clutch
- Hole type socket retainer
- Progressive throttle permits slow seating of bolt
- Inside trigger

BENEFITS

- Ideal for soft pull & prevailing torque joints
- Good handling & directional changes



RP9583

Easy access in tight areas

FEATURES

- Rocking dog clutch
- Friction ring socket retainer
- Progressive throttle permits slow seating of bolt
- 152mm (6") extended anvil
- Reverse valve

BENEFITS

- Ideal for soft pull & prevailing torque joints
- Good handling & directional changes
- Extended anvil for easy access

See accessories on page 9

MODEL	PART NUMBER	SQUARE DRIVE	FREE SPEED	WORKING TORQUE		MAXIMUM TORQUE		AIR CONSUMPTION		OVERALL LENGTH		NET WEIGHT		NOISE LEVEL	SOUND POWER	VIBRATION	AIR INLET
				Nm	ft lb	Nm	ft lb	l/s	cfm	mm	in.	kg	lb	dB(A)	dB(A)	m/s ²	NPTF
RP9548	615 190 9548	1	3,900	135-810	100-600	1285	950	18.4	39	226	8.90	5.75	12.6	97	108	8.0	3/8"
RP9582	615 190 9582	1	4,200	200-1225	150-900	1900	1400	18.9	40	394	15.5	12.3	27.0	110	121	4.3	1/2"
RP9583	615 190 9583	1	4,200	200-1225	150-900	1900	1400	18.9	40	564	22.2	13.5	29.8	110	121	4.3	1/2"
RP9597	615 190 9597	1	4,700	407-1898	300-1400	2712	2000	22.7	48	241	9.50	9.10	20.0	101	112	13.0	1/2"

@90 PSI(@6.3 Bar) - Listed specifications are for reference only. Please check documents in each tool.

Ratchet wrenches

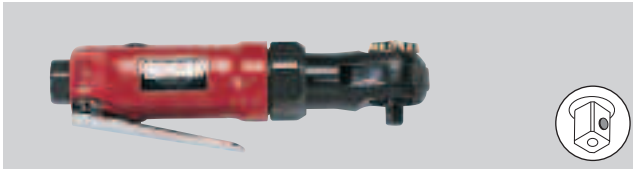

RP9425

Small & handy

FEATURES

- 1/4" square drive
- Progressive tease throttle
- One of the smallest ratchets, only 165mm (6.5") long
- Easy change reverse mechanism

BENEFITS

- Ideal for tight access applications
- Quick direction change
- Variable speed & torque output
- Pin retainer for quick socket change

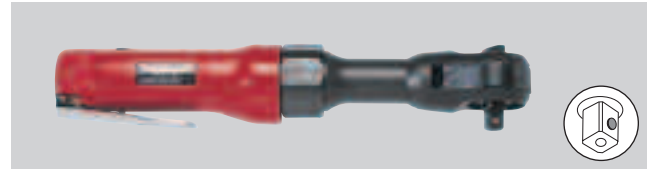

RP9429

High torque & Compact in 3/8"

FEATURES

- 3/8" square drive
- Full torque in reverse
- Compact head design

BENEFITS

- Ideal for disassembly operations
- High torque in small package
- Ideal for tight and deep access applications
- Pin retainer for quick socket change



RP9430

High torque & compact in 1/2"

FEATURES

- 1/2" square drive
- Full torque in reverse
- Compact head design

BENEFITS

- Ideal for disassembly operations
- High torque in small package
- Accommodates larger socket range
- Pin retainer for quick socket change



RP9431Q



Highest torque & low noise

FEATURES

- 3/8" square drive
- Highest torque available
- Low noise with only 79 dB(A)
- Full torque in reverse
- Lightweight composite body



RP9432Q



Same features as RP9431Q 1/2" square drive with accommodates larger socket range

BENEFITS

- Ideal for larger fasteners
- Ideal for disassembly operations
- Operator comfort
- Ratchet head protection
- Pin retainer for quick socket change

See accessories on page 9

MODEL	PART NUMBER	SQUARE DRIVE	FREE SPEED	TORQUE RANGE				AIR CONSUMPTION		OVERALL LENGTH		NET WEIGHT		NOISE LEVEL	SOUND POWER	VIBRATION	AIR INLET
				MIN.	MAX.	l/s	cfm	mm	in.	kg	lb						
RP9425	615 190 9425	1/4	200	7	5	20	15	4.7	10	165	6.5	0.85	1.9	87	98	6.2	1/4"
RP9429	615 190 9429	3/8	150	14	10	68	50	7.5	16	254	10	1.20	2.6	97	108	7.9	1/4"
RP9430	615 190 9430	1/2	150	14	10	68	50	7.5	16	254	10	1.20	2.6	97	108	7.9	1/4"
RP9431Q	615 190 9431	3/8	190	14	10	122	90	18.5	39	305	12	1.20	2.7	79	-	14.8	1/4"
RP9432Q	615 190 9432	1/2	190	14	10	122	90	18.5	39	305	12	1.20	2.7	79	-	14.8	1/4"

@90 PSI(@6.3 Bar) - Listed specifications are for reference only. Please check documents in each tool.

Socket sets

RediPower's new line of premium, high performance sockets combine strength, durability, looks and top quality. From the tough, chromemoly steel construction to the laser etched, easy to read socket size, these are the only impact sockets you'll ever need

PART N°	SQUARE DRIVE	DESCRIPTION	DIMENSION
894 015 899 6	3/8"	METRIC UNIVERSAL SOCKETS SET (7)	10, 12, 13, 14, 15, 17, 19mm
894 015 898 9	3/8"	METRIC SOCKETS SET (8)	9, 10, 12, 13, 14, 15, 17, 19mm
894 015 899 3	3/8"	DEEP METRIC SOCKETS SET (8)	9, 10, 12, 13, 14, 15, 17, 19mm
894 015 899 4	3/8"	DEEP METRIC SOCKETS SET (13)	7, 8, 9, 10, 11, 12, 13, 14, 15, 16, 17, 18, 19mm
894 015 898 8	3/8"	SAE/METRIC SOCKETS SET (12)	5/16", 3/8", 7/16", 1/2", 9/16", 5/8", 10, 12, 14, 15, 17, 19mm
894 015 899 2	3/8"	DEEP SAE/METRIC SOCKETS SET (12)	5/16", 3/8", 7/16", 1/2", 9/16", 5/8", 10, 12, 14, 15, 17, 19mm
894 015 900 2	1/2"	METRIC UNIVERSAL SOCKETS SET (7)	10, 12, 13, 14, 15, 17, 19mm
894 015 899 8	1/2"	METRIC SOCKETS SET (14)	10, 11, 12, 13, 14, 15, 16, 17, 18, 19, 21, 22, 26, 27mm
894 015 900 0	1/2"	DEEP METRIC SOCKETS SET (14)	10, 11, 12, 13, 14, 15, 16, 17, 18, 19, 21, 22, 26, 27mm
894 016 233 5	1/2"	DEEP METRIC THINWALL SOCKETS SET (3)	17, 19, 21mm
894 015 900 8	3/4"	DEEP METRIC SOCKETS SET (11)	17, 19, 21, 27, 30, 32, 33, 35, 36, 38, 41mm
894 015 901 2	1"	METRIC SOCKETS SET (9)	26, 27, 29, 30, 32, 33, 35, 36, 38mm
894 016 233 4	1"	DEEP METRIC SOCKETS SET (6)	24, 27, 30, 32, 33, 36mm

Sockets

3/8" SQUARE DRIVE DEEP

PART N°	NUT SIZE
894 016 193 1	7mm
894 016 193 2	8mm
894 016 193 3	9mm
894 016 193 4	10mm
894 016 193 5	11mm
894 016 193 6	12mm
894 016 193 7	13mm
894 016 193 8	14mm
894 016 193 9	15mm
894 016 194 0	16mm
894 016 194 1	17mm
894 016 194 2	18mm
894 016 194 3	19mm

3/8" SQUARE DRIVE STANDARD

PART N°	NUT SIZE
894 016 191 5	9mm
894 016 191 6	10mm
894 016 191 7	11mm
894 016 191 8	12mm
894 016 191 9	14mm
894 016 192 0	15mm
894 016 192 1	17mm
894 016 192 2	19mm

3/8" SQUARE DRIVE UNIVERSAL

PART N°	NUT SIZE
894 016 197 2	10mm
894 016 197 3	12mm
894 016 197 4	13mm
894 016 197 5	14mm
894 016 197 6	15mm
894 016 197 7	17mm
894 016 197 8	19mm

IMPACT COAT PROTECTOR COVERS

PART N°	FOR
CA146522	RP9524, RP9525, RP9526, RP9527
CA129405	RP9540
CA124745	RP9560
CA139818	RP9582, RP9583

1/2" SQUARE DRIVE DEEP

PART N°	NUT SIZE
894 016 186 1	10mm
894 016 186 2	11mm
894 016 186 3	12mm
894 016 186 4	13mm
894 016 186 5	14mm
894 016 186 6	15mm
894 016 186 7	16mm
894 016 186 8	17mm
894 016 186 9	18mm
894 016 187 0	19mm
894 016 187 1	21mm
894 016 187 2	22mm
894 016 187 3	26mm
894 016 187 4	27mm

1/2" SQUARE DRIVE STANDARD

PART N°	NUT SIZE
894 016 188 8	10mm
894 016 188 9	11mm
894 016 189 0	12mm
894 016 189 1	13mm
894 016 189 2	14mm
894 016 189 3	15mm
894 016 189 4	16mm
894 016 189 5	17mm
894 016 189 6	18mm
894 016 189 7	19mm
894 016 189 8	21mm
894 016 189 9	22mm
894 016 190 0	26mm
894 016 190 1	27mm
894 016 206 9	17 x 19mm
894 016 207 0	19 x 21mm

1/2" SQUARE DRIVE UNIVERSAL

PART N°	NUT SIZE
894 016 198 6	13mm
894 016 198 7	14mm
894 016 198 8	15mm
894 016 198 9	17mm
894 016 199 0	19mm
894 016 199 1	21mm
894 016 199 2	22mm

3/4" SQUARE DRIVE DEEP

PART N°	NUT SIZE
894 016 202 7	17mm
894 016 202 8	19mm
894 016 202 9	21mm
894 016 203 0	27mm
894 016 203 1	30mm
894 016 203 2	32mm
894 016 203 3	33mm
894 016 203 4	35mm
894 016 203 5	36mm
894 016 203 6	38mm
894 016 203 7	41mm

1" SQUARE DRIVE STANDARD

PART N°	NUT SIZE
894 016 204 7	26mm
894 016 204 8	27mm
894 016 204 9	29mm
894 016 205 0	30mm
894 016 205 1	32mm
894 016 205 2	33mm
894 016 205 3	35mm
894 016 205 4	36mm
894 016 205 5	38mm

RATCHETS PROTECTIVE COVER

PART N°	FOR
CA140128	RP9425
CA133961	RP9429
CA133961	RP9430
CA147993	RP9431
CA147993	RP9432

IMPACT SIDE HANDLE

PART N°	FOR
CA157821	Side Handle RP9582, RP9583
CA048548	Side Handle RP9597
C116388	Retainer for Side Handle RP9597

IMPACTS KITS



RP9546 IKIT - Imperial - Included:
 - 1/2" Impact wrench RP9546 (Qty 1)
 - Sockets (5) - 1/2", 5/8", 3/4", 7/8" and 5/16" AF
 - Bottle of air tool oil

RP9546 MKIT - Metric - Included:
 - 1/2" Impact wrench RP9546 (Qty 1)
 - Sockets (5) - 14, 16, 17, 19 & 22mm AF
 - Bottle of air tool oil

RP9550 IKIT - Imperial - Included:
 - 1/2" Impact wrench RP9540 (Qty 1)
 - Sockets (5) - 1/2", 5/8", 3/4", 7/8" and 5/16" AF

RP9551 MKIT - Metric - Included:
 - 3/4" Impact wrench RP9560 (Qty 1)
 - Sockets (4) - 15/16", 1", 1-1/16", 1-1/8" AF

RP9552 MKIT - Metric - Included:
 - 1/2" Impact wrench RP9540 (Qty 1)
 - Sockets (5) - 14, 16, 17, 19 & 22mm AF

RP9553 MKIT - Metric - Included:
 - 3/4" Impact wrench RP9560 (Qty 1)
 - Sockets (4) - 24, 27, 30 & 32mm

IMPACT NOSE SHIELD

PART N°	FOR
CA092063	RP9521, RP9523
CA145953	RP9522
KF136485	RP9524, RP9525, RP9526, RP9527
KF129085	RP9540, RP9550, RP9552
CA048467	RP9560, RP9551, RP9553



RediPower

Screwdrivers



Choosing the right Screwdriver

► Tool selection



- Type of fastener/component
- Joint integrity
- Torque required
- Tool orientation and ergonomics
- Productivity

1		Machine screw/nut
2		Self tapping/ Self drilling
3		Self tapping in plastic/ thin materials
4		Self lock
5		Wood screws

POSSIBLE USE OF SCREWS					MODEL	TYPE OF CLUTCH	START	TORQUE RANGE				FREE SPEED	PAGE	STRAIGHT OR PISTOL
1	2	3	4	5				MIN.		MAX.				
								Nm	in.lb	Nm	in.lb	rpm		
					RP2754	DIRECT	TRIGGER	-	-	5.0	44	1,450	12	
					RP2755	DIRECT	TRIGGER	-	-	14.0	124	2,200	12	
					RP2764	DIRECT	TRIGGER	-	-	14.0	124	600	12	
					RP2765	DIRECT	TRIGGER	-	-	26.0	230	900	12	
					RP2780	POSITIVE	TRIGGER	-	-	15.0	133	2,100	12	
					RP2036	IMPACT	LEVER	3.4	30.0	16.0	142	10,000	13	
					RP2037	IMPACT	LEVER	18.0	159	28.0	248	10,000	13	
					RP2041	IMPACT	TRIGGER	8.0	71.0	42.0	372	15,000	13	
					RP2042	IMPACT	TRIGGER	6.0	53.0	41.0	363	5,600	13	
					RP2003	SHUT OFF	PUSH	0.4	3.5	1.5	13	1,100	15	
					RP2007	SHUT OFF	PUSH	0.4	3.5	4.3	38	1,100	15	
					RP2010	SHUT OFF	PUSH	2.0	18.0	5.5	49	1,470	15	
					RP2008	SHUT OFF	LEVER	0.4	3.5	4.3	38	1,100	14	
					RP2012	SHUT OFF	LEVER	2.0	18.0	5.5	49	1,470	14	
					RP2005	SHUT OFF	TRIGGER	0.4	3.5	4.3	38	1,100	14	
					RP2015	SHUT OFF	TRIGGER	2.0	18.0	5.5	49	1,470	14	
					RP2009	ROLLER	LEVER	0.4	3.5	4.4	39	1,100	14	
					RP2011	ROLLER	LEVER	2.0	18.0	5.5	49	1,470	14	
					RP2006	ROLLER	TRIGGER	0.4	3.5	4.4	39	1,100	14	
					RP2014	ROLLER	TRIGGER	2.0	18.0	5.5	49	1,470	14	

This chart is only for your help in choosing the right screwdriver

Screwdrivers

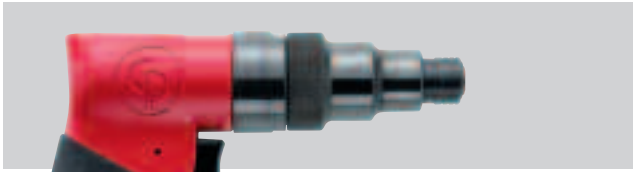

RP2780

Positive action clutch

FEATURES

- Positive clutch screwdriver
- Quick change chuck
- Reverse control at the trigger
- High speed & high torque
- Progressive trigger

BENEFITS

- Tool designed for wood applications
- Convenient one handed operation (side handle available as accessory)
- Good for prevailing torque applications
- Operator can force clutch engagement for higher torque

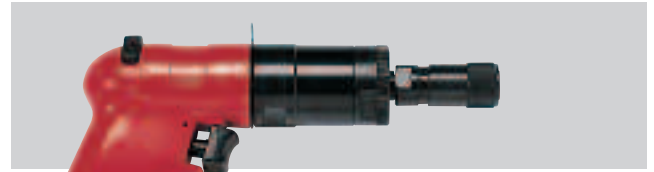

RP2754

Low noise

FEATURES

- Direct drive screwdriver
- Quick change chuck
- Reverse control on the top
- Ergonomic pistol handle
- Progressive trigger

BENEFITS

- Good for soft draw applications
- Simple maintenance
- Fast screw rundown

RP2764

Low speed and high torque up to 14Nm (124in.lb). Same features as RP2754

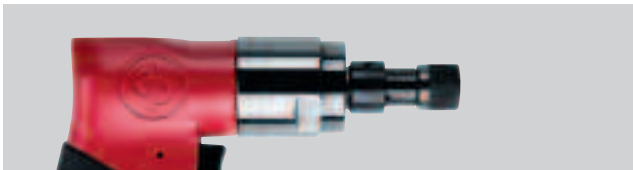

RP2755

High speed direct drive

FEATURES

- Direct drive screwdriver
- Quick change chuck
- Reverse control at the trigger
- High speed
- Ergonomic grip pistol
- Progressive trigger

BENEFITS

- Good for soft draw applications
- Simple maintenance
- Fast screw rundown



RP2765

High torque direct drive

FEATURES

- Direct drive screwdriver
- Quick change chuck
- Reverse control at the trigger
- Very high torque
- Ergonomic grip pistol
- Progressive trigger

BENEFITS

- Good for soft draw applications
- Simple maintenance
- Convenient one handed operation



See accessories on page 15

MODEL	PART NUMBER	FREE SPEED rpm	OUTPUT DRIVE in.	TORQUE RANGE				AIR CONSUMPTION		OVERALL LENGTH		NET WEIGHT		NOISE LEVEL dB(A)	VIBRATION m/s ²	AIR INLET NPTF
				MIN.	MAX.	l/s	cfm	mm	in.	kg	lb					
RP2754	615 192 2754	1,450	Hex. 1/4F	-	-	5	44	8	17	210	8.3	0.9	2.0	77	<2.5	1/4"
RP2755	615 192 2755	2,200	Hex. 1/4F	-	-	14	124	14	29	160	6.3	1.03	2.27	90	<2.5	1/4"
RP2764	615 192 2764	600	Hex. 1/4F	-	-	14	124	8	17	228	9.0	1.0	2.20	77	<2.5	1/4"
RP2765	615 192 2765	900	Hex. 1/4F	-	-	26	230	14	29	178	7.0	1.18	2.60	88	<2.5	1/4"
RP2780	615 192 2780	2,100	Hex. 1/4F	-	-	15	133	14	29	164	6.46	1.06	2.35	89	26.8	1/4"

@90 PSI(@6.3 Bar) - Listed specifications are for reference only. Please check documents in each tool.

Screwdrivers

RediPower



RP2036

Light tool

FEATURES

- Impact straight screwdriver
- Quick change chuck
- Reversible
- Built in power regulator
- Lever start
- Ergonomic

BENEFITS

- Quick torque adjustment
- Use for disassembly operations
- Ideal for multiple applications



RP2037

Compact & high torque

FEATURES

- Impact straight screwdriver
- Quick change chuck
- Reversible
- Power regulator
- Lever start
- Ergonomic
- High torque

BENEFITS

- Ideal for multiple application
- Improved productivity
- Durability



RP2041

High speed & high torque

FEATURES

- Impact pistol screwdriver
- Quick change chuck
- Reversible
- High torque
- High speed
- Ergonomic

BENEFITS

- Operator comfort
- One hand operation reverse valve
- Durability and productivity



RP2042

Compact & high torque

FEATURES

- Impact pistol screwdriver
- Quick change chuck
- Reversible
- High torque
- Low speed
- Ergonomic

BENEFITS

- Operator comfort
- One hand operation reverse valve
- Durability and productivity



See accessories on page 15

MODEL	PART NUMBER	FREE SPEED	OUTPUT DRIVE	TORQUE RANGE				AIR CONSUMPTION		OVERALL LENGTH		NET WEIGHT		NOISE LEVEL	VIBRATION	AIR INLET
				MIN.	MAX.	l/s	cfm	mm	in.	kg	lb					
RP2036	615 192 2036	10,000	Hex. 1/4F	3.4	30	16	142	6	13	223	8.78	0.78	1.73	83	6.9	1/4"
RP2037	615 192 2037	10,000	Hex. 1/4F	18	160	28	248	6	13	210	8.27	0.82	1.81	88	6.2	1/4"
RP2041	615 192 2041	15,000	Hex. 1/4F	8	71	42	372	9	19	152	5.98	1.04	2.29	89	4.8	1/4"
RP2042	615 192 2042	5,600	Hex. 1/4F	6	53	41	363	13	27	153	6.02	1.02	2.25	88	6.0	1/4"

@90 PSI(@6.3 Bar) - Listed specifications are for reference only. Please check documents in each tool.

Screwdrivers



RP2006

Great tool for multiple applications

FEATURES

- Roller clutch
- Compact pistol grip
- One hand operation reverse valve

BENEFITS

- Ideal for multiple applications
- Operator comfort
- Durability & quality

RP2005

Same features as RP2006 with Shut off clutch

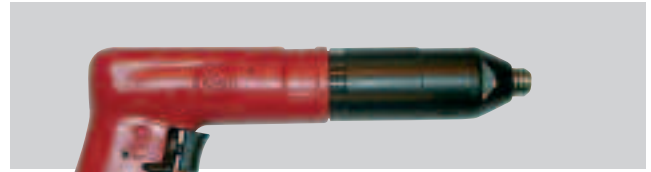

RP2014

High speed

FEATURES

- Roller clutch
- Ergonomic formed grip
- High speed and reversible

BENEFITS

- Ideal for multiple applications
- Fast screwfastening
- Durability & quality

RP2015

Same features as RP2014 with Shut off clutch



RP2009

Multiple applications

FEATURES

- Roller clutch
- Progressive lever start
- Reversible

BENEFITS

- Ideal for multiple applications
- Use for disassembly
- Ideal for centuring screws during the fastening cycle

RP2008

Same features as RP2009 with Shut off clutch



RP2011

Improved productivity

FEATURES

- Roller clutch
- Progressive lever start
- High speed and reversible
- Low noise level

BENEFITS

- Ideal for multiple applications
- Fast cycle times for productivity
- Ideal for centuring screws during the fastening cycle

RP2012

Same features as RP2011 with Shut off clutch

See accessories on page 15

MODEL	PART NUMBER	FREE SPEED	OUTPUT DRIVE	TORQUE RANGE				AIR CONSUMPTION		OVERALL LENGTH		NET WEIGHT		NOISE LEVEL	VIBRATION	AIR INLET
				MIN.		MAX.		l/s	cfm	mm	in.	kg	lb			
		rpm	in.	Nm	in.lb	Nm	in.lb						dB(A)	m/s ²	BSP	
RP2005	615 192 2005	1,100	Hex. 1/4F	0.4	3.5	4.3	38	6.5	14	182	7.2	0.8	1.8	76	<2.5	1/8"
RP2006	615 192 2006	1,100	Hex. 1/4F	0.4	3.5	4.4	39	6.5	14	182	7.2	0.8	1.8	75	2.3-3.9	1/8"
RP2008	615 192 2008	1,100	Hex. 1/4F	0.4	3.5	4.3	38	6.5	14	275	10.8	0.7	1.5	76	<2.5	1/8"
RP2009	615 192 2009	1,100	Hex. 1/4F	0.4	3.5	4.4	39	6.5	14	250	9.8	0.6	1.3	77	9-35	1/8"
RP2011	615 192 2011	1,470	Hex. 1/4F	2.0	18	5.5	49	9.0	20	278	10.9	0.9	2.0	73	16.1	1/4"
RP2012	615 192 2012	1,470	Hex. 1/4F	2.0	18	5.5	49	9.0	20	278	10.9	0.9	2.0	73	<2.5	1/8"
RP2014	615 192 2014	1,470	Hex. 1/4F	2.0	18	5.5	49	9.0	20	220	8.7	1.0	2.2	81	3.2	1/4"
RP2015	615 192 2015	1,470	Hex. 1/4F	2.0	18	5.5	49	9.0	20	220	8.7	1.0	2.2	81	<2.5	1/4"

@90 PSI(@6.3 Bar) - Listed specifications are for reference only. Please check documents in each tool.



RP2003

Compact and light tool

FEATURES

- Shut off clutch
- Push-to-start operation
- Reversible
- Fast and low torque
- Low noise level

RP2007

Same features as RP2003 with Shut off clutch

BENEFITS

- Ideal for continuous operation
- Reduce time during rework
- Positive shut off at preset torque



RP2010

High productivity

FEATURES

- Shut off clutch
- Push-to-start operation
- Reversible
- High speed
- Quick change reverse operation

BENEFITS

- Ideal for continuous operation
- Reduce time during rework
- Faster cycle times

See accessories on page 15

MODEL	PART NUMBER	FREE SPEED	OUTPUT DRIVE	TORQUE RANGE				AIR CONSUMPTION		OVERALL LENGTH		NET WEIGHT		NOISE LEVEL	VIBRATION	AIR INLET
				MIN.	MAX.	l/s	cfm	mm	in.	kg	lb	dB(A)	m/s ²			
RP2003	615 192 2003	1,100	Hex. 1/4F	0.4	3.5	1.5	13	4.1	9	197	7.7	0.4	0.9	73	<2.5	1/8"
RP2007	615 192 2007	1,100	Hex. 1/4F	0.4	3.5	4.3	38	6.5	14	250	9.8	0.6	1.3	81	<2.5	1/8"
RP2010	615 192 2010	1,470	Hex. 1/4F	2.0	18	5.5	49	9.0	20	253	10.0	0.9	2.0	76	<2.5	1/4"

@90 PSI(@6.3 Bar) - Listed specifications are for reference only. Please check documents in each tool.

Accessories



SUSPENSION BAIL

MODEL	PART No.
RP2005, RP2006	307683
RP2014, RP2015	473153
RP2012	467003

SIDE HANDLE

MODEL	PART No.
RP2755, RP2765, RP2780	205 049 854 3
RP2012, RP2014, RP2015	467033

SCREWDRIVER SLOT BIT

MODEL	PART No.
RP2036	894 020 079 1
RP2037	894 020 062 0
RP2041/RP2042	894 020 074 2

SCREWDRIVER KEY

MODEL	PART No.
RP2012/RP2007/RP2011/RP2008	29932
RP2009/RP2014/RP2010/RP2015	29932
RP2003	69773



RediPower

Drills



Choosing the right Drill



Pistol grip drills

- Ideal for all general industrial and maintenance drilling tasks
- Drilling hole capacity to 13mm (1/2") dia. (in steel)
- Best ergonomic shape - single and two handed use
- Use of side handle recommended for larger drills with high torque reaction



Straight drills





- Mainly smaller diameter drilling less than 10mm (3/8") dia. (in steel)
- Favoured for vertical drilling



Angle drills

- Ideal for restricted access application
- Drilling hole capacity to 10mm (3/8") dia. (in steel)

Drills range

TOOL TYPE	MODEL	FREE SPEED	CHUCK CAPACITY	
		rpm	mm	in.
PISTOL GRIP				
	RP1454	4,300	10	3/8
	RP9280	3,200	6.4	1/4
	RP1264/RP1274	2,900	10	3/8
	RP1064	2,500	10	3/8
	RP1664	2,000	10	3/8
	RP9285/RP9287	2,900	10	3/8
	RP9790/RP9792	2,000	10	3/8
	RP9789/RP9791	800	13	1/2
	RP9286/RP9288	600	13	1/2
STRAIGHT GRIP				
	RP9887	2,800	10	3/8
ANGLE DRILL				
	RP9879	1,300	10	3/8

Drills



RP1064

One tool for many applications

FEATURES

- 10mm (3/8") capacity chuck
- High-powered pistol drill
- Slim design - compact and lightweight

BENEFITS

- Ideal for close quarter drilling
- Accommodates wide range of drill bit sizes
- Good power for general drilling

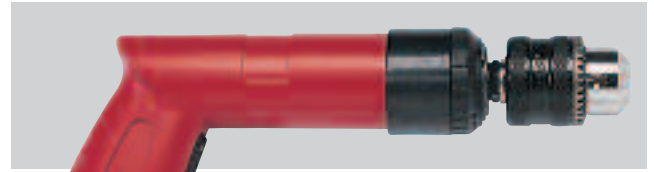

RP1454

High speed & power

FEATURES

- 10mm (3/8") capacity chuck
- High-powered, high-speed pistol drill
- Slim design - compact and lightweight

BENEFITS

- Ideal for close quarter drilling
- Accommodates wide range of drill bit sizes
- Good power and high speed for drilling



RP1664

One tool for 2 functions

FEATURES

- 10mm (3/8") capacity chuck
- Pistol drill with sliding reverse control
- Slim design - compact and lightweight



BENEFITS

- Can be used for drilling & screwing
- Quick change for forward and reverse
- Operator comfort



RP1264

Quiet and productive

FEATURES

- 10mm (3/8") capacity chuck
- Short, low-noise power drill
- High power & high speed
- Short length = manoeuvrability
- Streamlined and compact

BENEFITS

- Accommodates wide range of drill bit sizes
- High power and speed for improved cycle times
- Operator comfort

All models - vibration <2.5m²

See accessories on page 21

MODEL	PART NUMBER	FREE SPEED	POWER		CHUCK CAPACITY		SPINDLE THREAD	MAXIMUM TORQUE		AIR CONSUMPTION		OVERALL LENGTH		NET WEIGHT		NOISE LEVEL	AIR INLET
			kW	hp	mm	in.		in.	Nm	ft lb	l/s	cfm	mm	in.	kg		
RP1064	615 194 1064	2,500	0.23	0.30	10	3/8	3/8-24	1.8	1.32	9.3	19.7	225	8.9	0.7	1.5	83	1/4"
RP1454	615 194 1454	4,300	0.23	0.30	10	3/8	3/8-24	1.0	0.74	9.3	19.7	225	8.9	0.7	1.5	83	1/4"
RP1664	615 194 1664	2,000	0.19	0.26	10	3/8	3/8-24	1.8	1.32	9.3	19.7	225	8.9	0.7	1.5	83	1/4"
RP1264	615 194 1264	2,900	0.28	0.38	10	3/8	3/8-24	1.8	1.32	9.3	19.7	175	6.9	0.9	2.0	78	1/4"

@90 PSI(@6.3 Bar) - Listed specifications are for reference only. Please check documents in each tool.

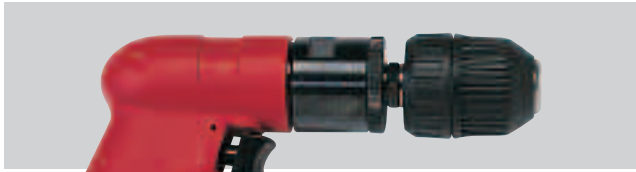

RP1274

Keyless chuck

FEATURES

- 10mm (3/8") capacity chuck
- Pistol grip drill with keyless chuck
- High speed

BENEFITS

- Power & high speed for improved cycle times
- Quick drill bit change
- Operator comfort and productivity



RP9280

Compact tool

FEATURES

- 6mm (1/4") capacity chuck
- Compact and lightweight pistol drill
- Progressive throttle

BENEFITS

- Ideal for drilling in close spaces
- Ease of handling
- Ideal for drill bit centering
- Ergonomic for operator's comfort'



RP9879

Angle drill for ease access

FEATURES

- 10mm (3/8") industrial capacity chuck
- Compact angle head drill
- Reversible



BENEFITS

- Ideal for tight access applications
- Good tool for both drilling and screwdriving
- Teasing throttle for for progressive control



RP9887

Powerful In-line drill

FEATURES

- 10mm (3/8") industrial capacity chuck
- In-line drill with contoured handle
- 0.5hp (0.37kW)

BENEFITS

- Ergonomic contoured body
- Good progressive grip
- Power and speed
- Durability and productivity
- Vertical or horizontal drilling

All models - vibration <2.5m²

See accessories on page 21

MODEL	PART NUMBER	FREE SPEED		POWER		CHUCK CAPACITY		SPINDLE THREAD	MAXIMUM TORQUE		AIR CONSUMPTION		OVERALL LENGTH		NET WEIGHT		NOISE LEVEL	SOUND POWER	AIR INLET
		rpm		kW	hp	mm	in.	in.	Nm	ft lb	l/s	cfm	mm	in.	kg	lb	dB(A)	dB(A)	NPTF
RP1274	615 194 1274	2,900		0.28	0.38	10	3/8	3/8-24	1.8	1.32	9.3	19.7	175	6.9	0.9	2.0	78	-	1/4"
RP9280	615 194 9280	3,200		0.23	0.30	6.4	1/4	3/8-24	2.6	1.92	9.0	19.0	142	5.6	0.6	1.3	82	-	1/4"
RP9879	615 194 9879	1,300		0.18	0.25	10	3/8	3/8-24	4.7	3.46	8.5	18.0	200	8.0	0.7	1.5	91	102	1/4"
RP9887	615 194 9887	2,800		0.37	0.50	10	3/8	3/8-24	4.7	3.46	12.0	26.0	215	8.5	0.9	2.0	88	99	1/4"

@90 PSI(@6.3 Bar) - Listed specifications are for reference only. Please check documents in each tool.

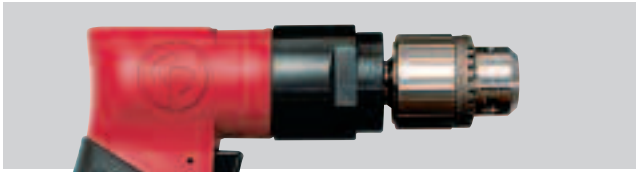

RP9285

Pistol drill

FEATURES

- 10mm (3/8") industrial capacity chuck
- Pistol drill with through-handle exhaust
- Versatile

BENEFITS

- Suitable for many applications
- Direct exhaust from the operator work piece
- Productivity and durability

RP9287



Keyless chuck
Same features as
RP9285

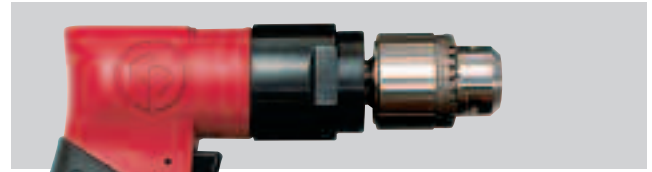

RP9790

Reversible pistol drill

RP9792



Keyless chuck
Same features as
RP9790

FEATURES

- 10mm (3/8") industrial capacity chuck
- Reversible pistol drill
- Through handle exhaust

BENEFITS

- Suitable for many applications
- Direct exhaust from the operator work piece
- Ideal for drilling and screwdriving

RP9790

Kits

Imperial and
Metric kits

See details on page 21



RP9286

Productive for larger holes

FEATURES

- 13mm (1/2") industrial capacity chuck
- Powerful pistol drill with through handle exhaust
- Low speed
- Side handle

BENEFITS

- Accommodates larger drill bits
- Direct exhaust from the operator work piece
- Ideal for large hole drilling



RP9288



Keyless chuck
Same features as RP9286

RP9789

Reversible and low speed

FEATURES

- 13mm (1/2") industrial capacity chuck
- Powerful reversible pistol drill with through handle exhaust
- Low speed and high power
- Side handle

BENEFITS

- Accommodates larger drill bits
- Direct exhaust from the operator work piece
- Ideal for drilling and screwdriving

RP9791



Reversible keyless
chuck
Same features as RP9789

All models - vibration <2.5m²

See accessories on page 21

MODEL	PART NUMBER	FREE SPEED		POWER		CHUCK CAPACITY		SPINDLE THREAD		MAXIMUM TORQUE		AIR CONSUMPTION		OVERALL LENGTH		NET WEIGHT		NOISE LEVEL	SOUND POWER	AIR INLET
		rpm		kW	hp	mm	in.	in.		Nm	ft lb	l/s	cfm	mm	in.	kg	lb			
RP9285	615 194 9285	2,900		0.38	0.50	10	3/8	3/8-24	5.3	3.91	10.0	21	165	6.5	1.1	2.4	89	100	1/4"	
RP9286	615 194 9286	600		0.38	0.50	13	1/2	3/8-24	20.0	14.70	11.5	24	177	7.0	1.8	4.0	90	101	1/4"	
RP9287	615 194 9287	2,900		0.38	0.50	10	3/8	3/8-24	5.3	3.91	10.0	21	199	7.83	1.15	2.5	89	100	1/4"	
RP9288	615 194 9288	600		0.38	0.50	13	1/2	3/8-24	20.0	14.70	11.5	24	251	9.88	1.51	3.3	90	101	1/4"	
RP9789	615 194 9789	800		0.27	0.37	13	1/2	3/8-24	12.4	9.14	11.5	24	177	7.0	1.8	4.0	90	101	1/4"	
RP9790	615 194 9790	2,000		0.27	0.37	10	3/8	3/8-24	4.8	3.54	11.5	24	165	6.5	1.4	3.0	89	100	1/4"	
RP9790 MKIT	615 194 0790	2,000		0.27	0.37	10	3/8	3/8-24	4.8	3.54	11.5	24	165	6.5	1.4	3.0	89	100	1/4"	
RP9790 IKIT	615 194 8790	2,000		0.27	0.37	10	3/8	3/8-24	4.8	3.54	11.5	24	165	6.5	1.4	3.0	89	100	1/4"	
RP9791	615 194 9791	800		0.27	0.37	13	1/2	3/8-24	12.4	9.14	11.5	24	237	9.33	1.42	3.1	90	101	1/4"	
RP9792	615 194 9792	2,000		0.27	0.37	10	3/8	3/8-24	4.8	3.54	11.5	24	216	8.5	1.18	2.6	89	100	1/4"	

@90 PSI(@6.3 Bar) - Listed specifications are for reference only. Please check documents in each tool.



DRILLS KITS

RP9790 IKIT - Imperial - Included:

- RP9790 Drill (Qty 1)
- Air nipple (1)
- Chuck key (1)
- Drill Bits (13) - 1/16", 5/64", 3/32", 7/64", 1/8", 9/64", 5/32", 11/64", 3/16", 13/64", 7/32", 15/64", 1/4"

RP9790 MKIT - Metric - Included:

- RP9790 Drill (Qty 1)
- Air nipple (1)
- Chuck key (1)
- Drill Bits (13) - 1.5, 2, 2.5, 3, 3.2, 3.5, 4, 4.5, 4.8, 5, 5.5, 6, 6.5mm



SCREWDRIVER KIT

DESCRIPTION	PART No.
For use with all Air Drills. Has Quick-Change Slip Chuck, three Phillips Bits and two Slotted Bits	CA155826



SIDE HANDLE	
MODEL	PART No.
RP9789/RP9791	205 049 855 3
RP9286/RP9288/ RP2755/RP2765	205 049 854 3



REAR EXHAUST HOSE ASSEMBLY NOISE REDUCER	
MODEL	PART No.
RP9285/RP9286/ RP9287/RP9288/ RP9789/RP9790/ RP9791/RP9792	205 051 649 3
RP9879/RP9887	205 051 290 3

TOOL	CAPACITY		THREAD MOUNT	CHUCK PART NUMBER	KEY PART NUMBER
	mm	in.	in.		
RP1064	10	3/8	3/8-24	40002	34302
RP1454	10	3/8	3/8-24	40002	34302
RP1664	10	3/8	3/8-24	40002	34302
RP1264	10	3/8	3/8-24	40002	34302
RP9280	6.4	1/4	3/8-24	205 048 698 3	205 049 700 3
RP9285	10	3/8	3/8-24	205 048 697 3 (Chuck + Key)	C142411
RP9286	13	1/2	3/8-24	205 048 696 3 (Chuck + Key)	C142411
RP9789	13	1/2	3/8-24	205 048 696 3 (Chuck + Key)	C142411
RP9790	10	3/8	3/8-24	205 048 697 3 (Chuck + Key)	C142411
RP9879	10	3/8	3/8-24	205 048 697 3 (Chuck + Key)	C142411
RP9887	10	38	3/8-24	205 048 697 3 (Chuck + Key)	C142411
RP1274	10	3/8	3/8-24	94952	
RP9791	13	1/2	3/8-24	205 050 207 3	
RP9792	10	3/8	3/8-24	205 050 206 3	
RP9287	10	3/8	3/8-24	205 050 206 3	
RP9288	13	1/2	3/8-24	205 050 207 3	

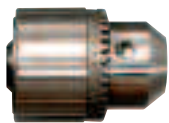



RediPower

Grinders



For maximum material removal with minimum effort, choose the best tool.

How to select your Grinder

▶ Collet grinders

Choose your tool, then your accessory:
carbide burrs, mounted points, brushes, flap wheels etc...



▶ Wheel grinders

Choose your tool, then your accessory:
depressed center wheels, cut-off wheels and flap wheels



Caution: the grinder should comply with the speeds recommended by component and abrasive manufacturers

Grinders



RP9104Q



RP9104Q KIT

*Kit available with 5 mounted points, 5 carbide burrs, 1/8" and 3mm collet
See details on page 28*

High speed precision work

FEATURES

- Compact pencil grinder
- 3mm and 1/8" collets included
- Noise level 71 dB(A)
- Good power to size ratio

BENEFITS

- Extremely easy to handle
- 2.4mm collet (optional)
- Quiet & lightweight
- Ideal for tight access application



RP9105

Speed & comfort

FEATURES

- Composite overmould
- 1/4" and 6mm collets included
- Variable speed regulator on air inlet
- Rear exhaust
- Safety lever to prevent accidental start up

BENEFITS

- Optimum speed selection
- 3mm, 1/8" collets (optional)
- Operator comfort and safety



RP9106

Easy access with angle head

FEATURES

- 90° angle head
- 1/4" and 6mm collets included
- Composite overmould
- Variable speed regulator on air inlet
- High speed

BENEFITS

- Easy accessibility
- 3mm, 1/8" collets (optional)
- Operator comfort and control



RP9108

Easy access with angle head

FEATURES

- 120° angle head
- 1/4" and 6mm collets included
- Composite overmould
- Variable speed regulator on air inlet
- High speed

BENEFITS

- Easy accessibility
- 3mm, 1/8" collets (optional)
- Operator comfort and control

See accessories on pages 28/29

MODEL	PART NUMBER	FREE SPEED	POWER		COLLET MAX CAPACITY		AIR CONSUMPTION		OVERALL LENGTH		NET WEIGHT		NOISE LEVEL	VIBRATION	AIR INLET
			rpm	kW	hp	mm	in.	l/s	cfm	mm	in.	kg			
RP9104Q	615 195 9104	60,000	0.04	0.054	3.2	1/8	3.5	7	133	5.2	0.2	0.5	71	8.3	1/4"
RP9104Q KIT	615 195 0104	60,000	0.04	0.054	3.2	1/8	3.5	7	133	5.2	0.2	0.5	71	8.3	1/4"
RP9105	615 195 9105	30,000	0.18	0.25	6.4	1/4	9.0	19	163	6.4	0.4	0.8	84	6.8	1/4"
RP9106	615 195 9106	25,000	0.18	0.25	6.4	1/4	9.0	19	165	6.5	0.5	1.1	84	3.6	1/4"
RP9108	615 195 9108	25,000	0.18	0.25	6.4	1/4	9.0	19	200	7.9	0.5	1.1	84	4.4	1/4"

@90 PSI(@6.3 Bar) - Listed specifications are for reference only. Please check documents in each tool.



Grinders

RediPower



RP9107

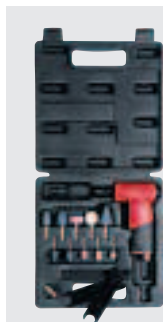

RP9107 Kits

Kits available in Imperial (IKIT) and Metric (MKIT) versions, with 10 mounted points
See details on page 28

2 fingered trigger

FEATURES

- Pistol grip
- 1/4" and 6mm collets included
- Adjustable speed regulator
- Through handle exhaust
- Good power to size ratio

BENEFITS

- Ideal for small horizontal applications
- 3mm, 1/8" collets (optional)
- Match speed to the job
- Operator comfort and control



RP9110

Speed & comfort

FEATURES

- Composite overmould
- 1/4" and 6mm collets included
- Variable speed regulator on air inlet
- Rear exhaust
- Safety Lever to prevent accidental start up

BENEFITS

- Optimum speed selection
- 3mm, 1/8" collets (optional)
- Operator comfort and safety



RP9111

Quiet power

FEATURES

- Composite body overmould
- 1/4" and 6mm collets included
- Variable top speed regulator
- High speed and power

BENEFITS

- Ergonomic grip
- 1/8" and 3mm collets (in optional)
- Operator comfort
- Direct exhaust air away from operator / workpiece

RP9111Q Kits

Kits available in Imperial (IKIT) and Metric (MKIT) versions, with 10 mounted points
See details on page 28



RP9112Q

Extended, quiet power

FEATURES

- Composite body overmould
- 1/4" and 6mm collets included
- Extended spindle
- High speed and power
- Variable top speed regulator
- Noise level: 80 dB(A)

BENEFITS

- Ergonomic grip
- 1/8" and 3mm collets (in optional)
- Operator comfort
- Ideal when longer reach is required



See accessories on pages 28/29

MODEL	PART NUMBER	FREE SPEED		POWER		COLLET MAX CAPACITY		AIR CONSUMPTION		OVERALL LENGTH		NET WEIGHT		NOISE LEVEL	VIBRATION	AIR INLET
		rpm		kW	hp	mm	in.	l/s	cfm	mm	in.	kg	lb	dB(A)	m/s ²	NPTF
RP9107	615 195 9107	17,000		0.15	0.2	6.4	1/4	8.5	16	120	4.7	0.7	1.5	81	<2.5	1/4"
RP9107 MKIT	615 195 0107	17,000		0.15	0.2	6.0	-	8.5	16	120	4.7	0.7	1.5	81	<2.5	1/4"
RP9107 IKIT	615 195 8107	17,000		0.15	0.2	6.4	1/4	8.5	16	120	4.7	0.7	1.5	81	<2.5	1/4"
RP9110	615 195 9110	30,000		0.18	0.25	-	1/4	9.0	19	256	10.0	0.7	1.5	84	4.0	1/4"
RP9111	615 195 9111	22,000		0.35	0.46	6.0	1/4	11.5	25	170	6.7	0.7	1.5	84	5.0	1/4"
RP9111Q MKIT	615 195 0111	22,000		0.35	0.46	6.0	-	11.5	25	170	6.7	0.7	1.5	80	5.0	1/4"
RP9111Q IKIT	615 195 8111	22,000		0.35	0.46	6.4	1/4	11.5	25	170	6.7	0.7	1.5	80	5.0	1/4"
RP9112Q	615 195 9112	22,000		0.35	0.46	6.0	1/4	11.5	25	330	13.0	1.3	2.9	80	3.5	1/4"

@90 PSI(@6.3 Bar) - Listed specifications are for reference only. Please check documents in each tool.



RP9114

High speed and efficient

FEATURES

- Adjustable power regulator
- 1/4" and 6mm collets included
- Lock-off throttle

BENEFITS

- Operator comfort
- Precise control and safety
- Productivity



RP9113

Powerful and efficient

FEATURES

- Adjustable power regulator
- 1/4" and 6mm collets included
- Lock-off throttle
- High power and rugged motor
- Square handle design for positive grip

BENEFITS

- Operator comfort
- Precise control and safety
- Durability & productivity



RP9101

Angle Head

FEATURES

- Mini angle die grinder
- 1/4" and 6mm collets included
- Compact and lightweight tool
- Built in regulator

BENEFITS

- Operator comfort
- Ideal tool for access in confined areas

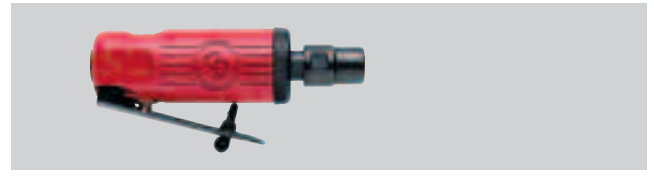

RP9102

High speed in a mini tool

FEATURES

- Mini die grinder
- 1/4" and 6mm collets included
- Compact and lightweight tool
- Built in regulator
- High speed

BENEFITS

- Operator comfort
- Ideal tool for access in confined areas



See accessories on pages 28/29

MODEL	PART NUMBER	FREE SPEED	POWER		COLLET MAX CAPACITY		AIR CONSUMPTION		OVERALL LENGTH		NET WEIGHT		NOISE LEVEL	VIBRATION	AIR INLET
		rpm	kW	hp	mm	in.	l/s	cfm	mm	in.	kg	lb	dB(A)	m/s ²	NPTF
RP9101	615 195 9101	22,500	0.15	0.20	6.4	1/4	11.0	23	122	4.80	0.45	1.0	101	3.0	1/4"
RP9102	615 195 9102	30,000	0.22	0.30	6.4	1/4	12.0	25	121	4.75	0.34	0.75	96	5.4	1/4"
RP9113	615 195 9113	24,000	0.37	0.50	6.4	1/4	10.5	22	146	5.75	0.57	1.25	92.6	4.8	1/4"
RP9114	615 195 9114	22,000	0.30	0.40	6.4	1/4	13.0	27	146	5.75	0.57	1.25	101	<2.5	1/4"

@90 PSI(@6.3 Bar) - Listed specifications are for reference only. Please check documents in each tool.



Grinders

RediPower



RP9118

Mini tool for easy access

FEATURES

- Ø 51mm (2") disc angle grinder
- Compact and lightweight tool
- 90° angle grinder
- High speed
- 3 discs included
- Safety lever

BENEFITS

- Operator comfort
- Easy manoeuvrability
- Ideal tool for applications in confined areas



RP9120

Lighweight & easy handling

FEATURES

- Ø 100mm (4") disc angle grinder
- Alloy body
- Powerful motor
- Side handle supplied

BENEFITS

- High performance
- Lightweight durability
- Easy handling



RP9121

Lighweight & easy handling

FEATURES

- Ø 127mm (5") disc angle grinder
- Alloy body
- Powerful motor
- Side handle supplied

BENEFITS

- High performance
- Lightweight durability
- Easy handling

RP9122

Same features as RP9121 with Ø 114mm (4.5") disc angle grinder

RP9122B

Same features as RP9122 with 5/8"-11 spindle thread



RP9123

Power & durability

FEATURES

- Ø 178mm (7") disc angle grinder
- Alloy body
- Powerful motor
- Left or right hand side handle supplied
- Protective rubber grip

BENEFITS

- High performance and comfort
- Easy handling
- Durability

See accessories on pages 28/29

MODEL	PART NUMBER	FREE SPEED	POWER		CAPACITY WHEEL		SPINDLE THREAD	AIR CONSUMPTION		OVERALL LENGTH		NET WEIGHT		NOISE LEVEL	VIBRATION	AIR INLET
			rpm	kW	hp	mm		in.	in.	l/s	cfm	mm	in.			
RP9118	615 195 9118	20,000	0.175	0.24	51	2.0	3/8-24	4.0	8	140	5.5	0.6	1.2	81	8.5	1/4"
RP9120	615 195 9120	14,000	0.5	0.68	102	4.0	3/8-24	10.0	21	229	9	1.8	4.0	84	7.5	1/4"
RP9121	615 195 9121	12,000	0.5	0.68	127	5.0	3/8-24	10.0	21	229	9	1.9	4.2	84	8.1	1/4"
RP9122	615 195 9122	12,000	0.5	0.37	114	4.5	3/8-24	10.0	21	229	9	1.9	4.2	84	8.1	1/4"
RP9122B	615 195 7122	12,000	0.5	0.37	114	4.5	5/8-11	10.0	21	229	9	1.9	4.2	84	8.1	1/4"
RP9123	615 195 9123	7,500	0.85	1.12	178	7.0	5/8-11	19.0	40	340	13.4	3.4	7.5	93	<2.5	1/4"

@90 PSI(@6.3 Bar) - Listed specifications are for reference only. Please check documents in each tool.

Accessories

GRINDERS KITS



RP9104Q KIT - Included:

- RP9104Q Pencil grinder (Qty 1)
- Spanner (1)
- 1/8" and 3mm collets included
- 2.4mm collet (1)
- Carbide burrs 3mm (5)
- Mounted points 3mm (5)



RP9107 IKIT - Imperial - Included:

- RP9107 Pistol grip grinder (Qty 1)
- Spanners (2)
- 1/4" collet installed
- 1/8" collet (1)
- Mounted points 1/4" (5), 1/8" (5)



RP9111Q IKIT - Imperial - Included:

- RP9111 Collet grinder (Qty 1)
- 1/4" collet installed
- 1/8" collet (1)
- Mounted points 1/4" (5), 1/8" (5)



RP9111Q MKIT - Imperial - Included:

- RP9111 Collet grinder (Qty 1)
- 6mm collet installed
- 3mm collet (1)
- Mounted points 6mm (5), 3mm (5)

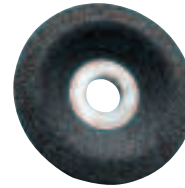

ACCESSORIES INCLUDED WITH THE TOOL RP9118

DESCRIPTION	PART No.
Cutting wheel 60 Grip (1)	894 016 276 8
Cutting wheel 80 Grip (1)	894 016 276 9
Cutting wheel 120 Grip (1)	894 016 277 0
Pin wrench	894 016 276 3
Spanner	894 016 275 9
Nuts	894 016 276 5



REAR EXHAUST HOSE ASSEMBLY - NOISE REDUCER

MODEL	PART No.
RP9111/12Q	205 051 649 3



COLLET ADAPTER

MODEL	PART No.
FOR ANY 1/4" Collet die grinder - Allows use of 1/8" shank burrs	C123029

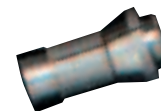

COLLET

MODEL	CAPACITY	PART No.
RP9104	2,4 mm	205 050 788 3
RP9104	3 mm	205 048 650 3
RP9101/02/05/06/07/08/10/11/12Q/13/14	3 mm	205 048 429 2
RP9104	1/8"	205 050 787 3
RP9101/02/05/06/07/08/10/11/12Q/13/14	1/4"	205 048 429 3
RP9101/02/05/06/07/08/10/11/12Q/13/14	6 mm	205 049 583 3
RP9101/02/05/06/07/08/10/11/12Q/13/14	1/8"	205 051 662 3
RP9101/02/05/06/07/08/10/11/12Q/13/14	1/4"	C138627

GUARD - FLANGE & FLANGE NUT - SPANNER & KEY

MODEL	DESCRIPTION	PART No.
RP9120	Disc Guard	205 048 487 3
	Flange	205 048 488 3
	Flange Nut	205 048 489 3
	Spanner	205 048 499 3
	Pin wrench	205 048 500 3
	Side Handle	205 048 501 3
RP9121	Disc Guard	205 048 666 3
	Flange	205 048 713 3
	Flange Nut	205 048 712 3
	Spanner	205 048 499 3
	Pin wrench	205 048 667 3
	Side Handle	205 048 501 3
RP9122	Disc Guard	205 049 756 3
	Flange	205 048 713 3
	Flange Nut	205 048 712 3
	Spanner	205 048 499 3
	Pin wrench	205 048 667 3
	Side Handle	205 048 501 3
RP9123	Disc Guard	205 050 097 3
	Flange	205 050 096 3
	Flange Nut	205 050 098 3
	Side Handle	205 050 119 3
	HEX. Key Wrench	205 050 121 3
	Complete Sanding kit ϕ 125mm thread pad 5/8"x11	205 049 853 3
RP9111/RP9112Q	Double Ended Spanner	205 049 645 3
	Spanner	205 049 644 3
RP9105/RP9106/RP9107/ RP9108/RP9110/RP9776	Spanner (2)	205 048 442 3

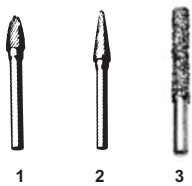

1/4" CARBIDE BURRS

N°	PART No.
1	C056721
2	C056722
3	KF137769



1/4" CARBIDE RASPS

N°	PART No.
4	KF137770
5	KF137771
6	KF137772

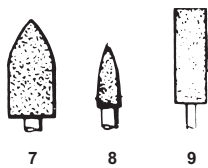

GENERAL PURPOSE MOUNTED WHEELS 1/4"

N°	MAX. SPEED rpm	PART No.	N°	MAX. SPEED rpm	PART No.
7	38,050	C085067	10	32,950	C085075
8	50,050	C085068	11	27,780	C085070
9	31,070	C085074	12	35,510	C085069

TUNGSTEN CARBIDE BURRS 3mm Ø SHANK

N°	A		B		PART No.
	mm	in.	mm	in.	
9	3	1/8	13	1/2	38122
10	3	1/8	13	1/2	38132
11	3	1/8	8	5/16	38142
12	3	1/8	3	1/8	38152
13	3	1/8	8	5/16	38162
14	3	1/8	8	5/16	38172

TUNGSTEN CARBIDE BURRS 6mm Ø SHANK

N°	A		B		PART No.
	mm	in.	mm	in.	
15	6	1/4	13	1/2	38182
16	6	1/4	16	5/8	38192
17	6	1/4	19	3/4	38202
18	6	1/4	6	1/4	38222
19	10	3/8	19	3/4	36122
20	10	3/8	19	3/4	36132
21	10	3/8	19	3/4	36142
22	10	3/8	10	3/8	38232

COLLET GRINDER ACCESSORIES Aluminium Oxide Mounted Points are available in red grades. Red grades are suitable for grinding high tensile materials such as ordinary and alloy steels, high speed steel and annealed malleable iron.

MOUNTED POINTS 3mm Ø SHANK - RED

N°	MAX SPEED* rpm	A		B		PART No.
		mm	in.	mm	in.	
1	104,000	5	0.19	5	0.19	38582
3	104,000	5	0.19	8	0.31	38522
6	81,000	6	0.25	6	0.25	38632
7	105,000	4	0.16	4	0.16	38562
8	81,000	6	0.25	6	0.25	38542

MOUNTED POINTS 6mm Ø SHANK - RED

N°	MAX SPEED* rpm	A		B		PART No.
		mm	in.	mm	in.	
1	59,000	16	0.62	16	0.62	435983
2	50,000	20	0.79	16	0.62	435993
3	45,000	20	0.79	28	1.10	436003
4	48,000	20	0.79	32	1.26	436013
5	53,000	20	0.79	22	0.88	436023
6	40,000	13	0.51	25	1.00	436033
6	38,000	25	1.00	3	0.11	436043

* Maximum permissible speed with 12.7mm or 1/2" spindle overhang.

COLLET GRINDER ACCESSORIES - Tungsten Carbide Burrs are suitable for cutting unhardened and hardened steels, stainless, weld seams, steelcastings, light and non-ferrous metals or plastics.



RediPower

Sanders



How to select your Sander/Polisher

Two types of Sanders can be used depending on the accessories required.

► Finishing sanders

From the standard to modular sanders 4-in-1. Self vacuum or central vacuum. Many solutions are available for your needs.



► Disc sanders or belt sanders

A complete range to suit your finishing surface applications for specific abrasives.

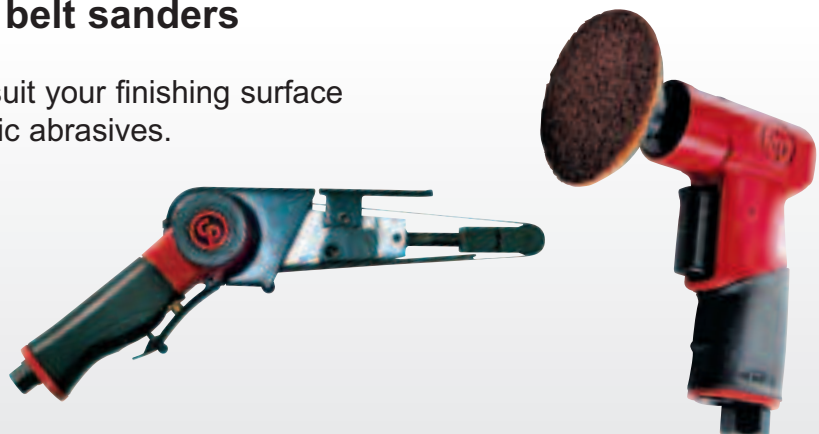



Sanders



RP9534

4-in-1 modular sander

FEATURES

- 3/16" (5mm) random orbital
- High quality "hook-it" sanding pad
- Low vibration tool



3/16" (5mm)
random orbit
version for
finishing sanding

BENEFITS

- Can be configured to suit application and operator
- Long lasting
- Ideal for fine finishing operations



RP9674

4-in-1 modular sander

FEATURES

- 3/8" (10mm) random orbital
- High quality "hook-it" sanding pad
- Low vibration tool

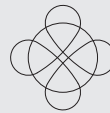

3/8" (10mm)
random orbit
version for
fast material removal

BENEFITS

- Can be configured to suit application and operator
- Long lasting
- Ideal for fast material removal



RP9164

General duty

FEATURES

- Rotary or random orbital options
- Sure-grip insulated handle
- Crossbolt-style hub mounting minimizes vibration

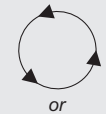

or



3/8" (10mm)
random orbit
or rotary version,
for finishing random,
for fast material removal

BENEFITS

- Ideal for multiple applications
- Ideal for fast material removal
- Operator comfort



RP9778

Fast and precise

FEATURES

- High speed sander
- Variable speed throttle
- Compact and lightweight
- Low vibration



BENEFITS

- Ideal for tight access work
- Precise control
- Easy handling
- Flexibility

See accessories on page 35

MODEL	PART NUMBER	FREE SPEED	PAD SIZE		SPINDLE THREAD	AIR CONSUMPTION		OVERALL LENGTH		NET WEIGHT		NOISE LEVEL	SOUND POWER	VIBRATION	AIR INLET
		rpm	mm	in.	in.	l/s	cfm	mm	in.	kg	lb	dB(A)	dB(A)	m/s ²	NPTF
RP9164	615 193 9164	9,600	152	6	5/16-24	8.80	18	222	8.75	1.7	3.8	90	101	7.3	1/4"
RP9534	615 193 9534	9,000	152	6	5/16-24	8.97	19	190	7.5	1.3	2.9	83	-	<2.5	1/4"
RP9674	615 193 9674	9,000	152	6	5/16-24	8.97	19	190	7.5	1.3	2.9	83	-	<2.5	1/4"
RP9778	615 193 9778	18,500	127	5	7/16-20	12.0	26	203	8.0	1.0	2.3	90	101	<2.5	1/4"

@90 PSI(@6.3 Bar) - Listed specifications are for reference only. Please check documents in each tool.

Sanders

RediPower



RP9775

Mini random orbital sander

FEATURES

- Mini random orbital sander
- Compact and lightweight
- Handle rubber grip
- Two-finger throttle for easy control
- Silenced handle exhaust directs air away



BENEFITS

- Compact and lightweight for easy control
- Operator comfort
- Less fatigue
- Ideal for small surface

RP9775 Kit

Mini random orbital Sander Kit
See details on page 34



RP9777

Mini disc polisher

FEATURES

- Mini disc polisher
- Compact and lightweight
- Two-finger throttle for easy control
- Silenced handle exhaust directs air away
- Low vibration



BENEFITS

- Compact and lightweight for easy control
- Operator comfort
- Less fatigue
- Ideal for small surface

RP9777 KIT

Mini disc Polisher Kit
See details on page 34



RP9776

Mini rotary sander

FEATURES

- Compact and Lightweight
- Adjustable speed regulator
- Through handle exhaust
- Rubber moulded grip

BENEFITS

- Ideal for small work areas
- Match the speed for the job
- Operator comfort

RP9776 KIT

Mini rotary Sander Kit
See details on page 34



See accessories on page 35

MODEL	PART NUMBER	FREE SPEED	PAD SIZE		SPINDLE THREAD	AIR CONSUMPTION		OVERALL LENGTH		NET WEIGHT		NOISE LEVEL	SOUND POWER	VIBRATION	AIR INLET
		rpm	mm	in.	in.	l/s	cfm	mm	in.	kg	lb	dB(A)	dB(A)	m/s ²	NPTF
RP9775	615 193 9775	15,000	75	3	1/4-20F	4.95	10.5	120	4.72	0.68	1.50	86	97	7.1	1/4"
RP9775 KIT	615 193 0775	15,000	75	3	1/4-20F	4.95	10.5	120	4.72	0.68	1.50	86	97	7.1	1/4"
RP9776	615 193 9776	14,000	75	3	1/4-20	8.90	19.0	121	4.70	0.70	1.50	77	-	<2.5	1/4"
RP9776 KIT	615 193 0776	14,000	75	3	1/4-20	8.90	19.0	121	4.70	0.70	1.50	77	-	<2.5	1/4"
RP9777	615 193 9777	2,500	75	3	1/4-20F	4.95	10.5	130	5.11	0.79	1.75	88	99	<2.5	1/4"
RP9777 KIT	615 193 0777	2,500	75	3	1/4-20F	4.95	10.5	130	5.11	0.79	1.75	88	99	<2.5	1/4"

@90 PSI(@6.3 Bar) - Listed specifications are for reference only. Please check documents in each tool.

Sanders



RP9779

Compact and Lightweight

FEATURES

- 10mm (0.4") belt capacity
- High speed
- Swivel air inlet and adjustable arm
- Arm locks in place for easy belt change

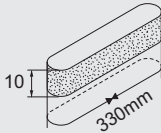

BENEFITS

- Excellent for paint and rust removal, and weld sanding
- Easy access in tight areas
- Operator comfort



RP9780

Flexible and easy handling

FEATURES

- 20mm (0.9") belt capacity
- High power
- Swivel air inlet and adjustable arm
- Arm locks in place for easy belt change

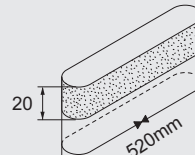

BENEFITS

- Excellent for paint and rust removal, and weld sanding
- Easy access in tight areas
- Operator comfort

See accessories on page 35

MODEL	PART NUMBER	FREE SPEED	BELT SIZE		POWER		AIR CONSUMPTION		OVERALL LENGTH		NET WEIGHT		NOISE LEVEL	SOUND POWER	VIBRATION	AIR INLET
		rpm	mm	in.	W	hp	l/s	cfm	mm	in.	kg	lb	dB(A)	dB(A)	m/s ²	NPTF
RP9779	615 193 9779	22,000	10x330	0.4x13	260	0.35	13.3	28	305	12.0	0.90	1.98	90.5	101.5	<2.5	1/4"
RP9780	615 193 9780	20,000	20x520	0.9x20.4	380	0.51	14.6	30	380	15.0	1.50	3.30	90.5	101.5	<2.5	1/4"

@90 PSI(@6.3 Bar) - Listed specifications are for reference only. Please check documents in each tool.

Accessories

SANDERS KITS



RP9776 KIT - Included:

- RP9776 Mini rotary Sander (Qty 1)
- ø 50mm (2") Sanding backing pad (1)
- ø 50mm (2") 60 Grit sanding disc (10)
- ø 50mm (2") 80 Grit sanding disc (10)
- ø 50mm (2") 120 Grit sanding disc (10)
- ø 50mm (2") Surface preparation pad (fine, medium, coarse) (3)
- ø 75mm (3") Sanding backing pad (1)
- ø 75mm (3") 60 Grit sanding disc (10)
- ø 75mm (3") 80 Grit sanding disc (10)
- ø 75mm (3") 120 Grit sanding disc (10)
- ø 75mm (3") Surface preparation pad (fine, medium, coarse) (3)
- Spanner (1)



P9775 KIT - Included:

- RP9775 Mini random orbital Sander (Qty 1)
- ø 50mm (2") Sanding backing pad (1)
- ø 75mm (3") Sanding backing pad (1)
- ø 50mm (2") 320 Grit banding disc (10)
- ø 50mm (2") 400 Grit banding disc (10)
- ø 50mm (2") 600 Grit banding disc (10)
- Spindle wrench (1)



RP9777 KIT - Included:

- RP9777 Mini disc Polisher (Qty 1)
- ø 75mm (3") Backing pad (1)
- ø 75mm (3") Foam compounding pad (white/yellow) (2)
- ø 75mm (3") Wool buffing pad (1)
- Spindle wrench (1)

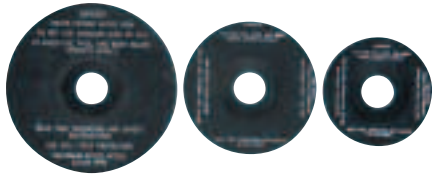

BACKING PADS		
MODEL		PART NUMBER
RP9778	ø 75mm (3") Backing Pad	205 048 506 3
RP9778	ø 110mm (4-1/2") Back-up	205 048 507 3
RP9778	ø 125mm (5-1/2") Back-up	205 048 508 3

SANDING ACCESSORIES		
MODEL		PART NUMBER
RP9778	Flange	205 048 505 3
RP9778	Hub	205 048 503 3
RP9778	Rod-Key	205 048 504 3

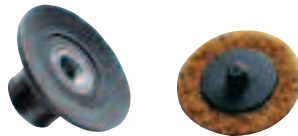
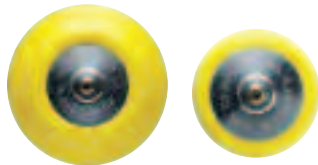

SANDING PADS		
MODEL		PART NUMBER
RP9534/9674	ø 150mm (6") PSA pad	KF140658
RP9534/9674	ø 150mm (6") Velcro pad	CA149405
RP9534/9674	ø 150mm (6") PSA pad - 6 holes dust ext.	CA142413
RP9534/9674	ø 150mm (6") Velcro pad - 6 holes dust ext.	CA149784
RP9534/9674	Pad and Disc kit	352493
RP9534/9674	ø 150mm (6") Pad - 6 holes dust ext.	615 990 118 0
RP9534/9674	ø 150mm (6") Velcro pad - 6 holes dust ext.	615 990 126 0
RP9534/9674	Keys for pad	164433
RP9534/9674	Complete dust extraction kit	894 015 843 0
RP9164	ø 150mm (6") Sanding pad	205 048 825 3
RP9164	ø 150mm (6") Pad for self-adhesive abrasive	615 990 119 0
RP9164	ø 150mm (6") Velcro pad	615 990 125 0
RP9775	ø 75mm (3") Sanding pad for Hook & Loop abrasive	894 015 833 0
RP9775	ø 50mm (2") Sanding pad for Hook & Loop abrasive	894 015 833 4
RP9775	Key	CA158089
RP9775	Spacer	CA158082
RP9776	ø 75mm (3") Sanding backing pad	205 048 711 3
RP9776	ø 75mm (3") Sanding disc 60 grit (5)	894 016 171 2
RP9776	ø 75mm (3") Sanding disc 80 grit (5)	894 016 171 3
RP9776	ø 75mm (3") Sanding disc 100 grit (5)	894 016 171 4
RP9776	ø 75mm (3") Sanding disc 120 grit (5)	894 016 171 5
RP9776	ø 75mm (3") Surface prep. pad (Fine) (5)	894 016 171 6
RP9776	ø 75mm (3") Surface prep. pad (Medium) (5)	894 016 171 7
RP9776	ø 75mm (3") Surface prep. pad (Course) (5)	894 016 171 8

POLISHING PADS		
MODEL		PART NUMBER
RP9776	ø 75mm (3") Soft polishing white pads	CA158108
RP9776	ø 75mm (3") Hard polishing yellow pads	CA158109
RP9776	ø 75mm (3") Buffing wool pads	CA158110
RP9776	ø 50mm (2") Soft polishing white pads	894 015 877 2
RP9776	ø 50mm (2") Hard Polishing Yellow Pads	894 015 877 3
RP9776	ø 50mm (2") Bugging wool pads	894 015 877 4
RP9777	ø 75mm (3") Soft polishing pad	CA158108
RP9777	ø 75mm (3") Hard polishing pad	CA158109
RP9777	ø 75mm (3") Buffing pad	CA158110
RP9777	ø 50mm (2") Soft polishing pad	894 015 877 2
RP9777	ø 50mm (2") Hard buffing pad	894 015 877 3
RP9777	ø 50mm (2") Buffing pad	894 015 877 4
RP9777	Wrench	CA158083
RP9777	Spacer	CA158082

BELT SANDER KEY		
MODEL		PART NUMBER
RP9779/RP9880	Hex. Key wrench (4mm)	205 050 026 3
RP9880	Hex. Key wrench (2.5mm)	205 050 027 3

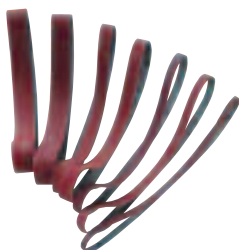

BELT SANDERS – BAGS OF 5 BELLS				
MODEL		PART NUMBER	MODEL	PART NUMBER
RP9779	Belts 60 Grit (10 x 330mm) (5)	205 050 444 3	RP9780	Belts 60 Grit (20 x 520mm) (5)
RP9779	Belts 80 Grit (10 x 330mm) (5)	205 050 445 3	RP9780	Belts 80 Grit (20 x 520mm) (5)
RP9779	Belts 100 Grit (10 x 330mm) (5)	205 050 446 3	RP9780	Belts 100 Grit (20 x 520mm) (5)
RP9779	Belts 120 Grit (10 x 330mm) (5)	205 050 447 3	RP9780	Belts 120 Grit (20 x 520mm) (5)



RediPower

Hammers



How to select your Hammer

Determine the required tool for the application:

▶ **Standard chipping hammers**

Chipping hammers with a unique vibration damping body to improve operator comfort and to minimize fatigue.

▶ **Standard Needle Scaler/ Chipping Hammer**

- 2-in-1 needle scaler & chipping hammer
- Quick change retainer spring.



Hammers

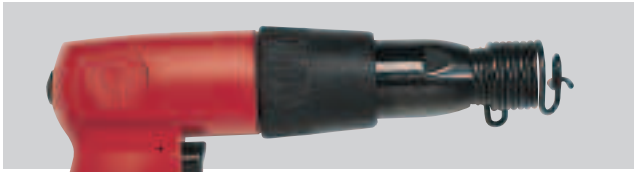

RP9536

Reduced vibrations

FEATURES

- Aluminium body
- Round shank
- Powerful
- Unique vibration damping
- Touch trigger for progressive control

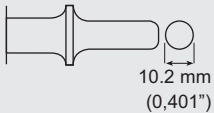

BENEFITS

- Improved operator comfort
- Less operator vibration
- Slow start up for better control



RP9537

Reduced vibrations

FEATURES

- Higher cold rivet capacity
- Round shank
- Unique vibration damping
- Touch trigger for precision start

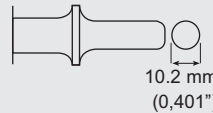

BENEFITS

- Improved operator comfort
- Less operator vibration
- Slow start up for better control



RP9311

Standard duty air hammer

FEATURES

- Aluminium body
- Round shank
- Powerful & cost effective
- Quick change retainer spring

BENEFITS

- Withstands rugged
- Fast and easy chisel change
- Durability

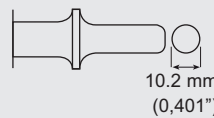

RP9311 Kit

with 5 round Chisels
See details on page 40



See accessories on pages 40/41

MODEL	PART NUMBER	COLD RIVET CAP. (DURAL)		COLD RIVET CAP. (STEEL)		BORE AND STROKE		BLOWS PER MIN.	CHISEL RIVET SET SHANK		AIR CONS.		OVERALL LENGTH		NET WEIGHT		NOISE LEVEL	SOUND POWER	VIBRATION	AIR INLET
		mm	in.	mm	in.	mm	in.		mm	in.	l/s	cfm	mm	in.	kg	lb	dB(A)	dB(A)	m/s ²	NPTF
RP9536	615 196 9536	6.4	1/4	4.8	3/16	19x67	3/4x2 ^{5/8}	3,200	10.2	0.401	7.0	14	230	9.0	1.7	3.7	97	108	5.9	1/4"
RP9537	615 196 9537	7.9	5/16	6.4	1/4	19x90	3/4x3 ^{1/2}	2,200	10.2	0.401	8.0	17	280	11.0	2.1	4.6	95	106	4.2	1/4"
RP9311	615 196 9311	6.4	1/4	4.8	3/16	19x67	3/4x2 ^{5/8}	3,000	10.2	0.401	11.8	25	171	6.7	1.6	3.5	100	111	8.9	1/4"
RP9311 KIT	615 196 0311	6.4	1/4	4.8	3/16	19x67	3/4x2 ^{5/8}	3,000	10.2	0.401	11.8	25	171	6.7	1.6	3.5	100	111	8.9	1/4"

@90 PSI(@6.3 Bar) - Listed specifications are for reference only. Please check documents in each tool.



RP9312

Standard duty air hammer

FEATURES

- Aluminium body
- Hexagonal shank
- Powerful & cost effective
- Quick change retainer spring

BENEFITS

- Withstands tough use
- Fast and easy chisel change
- Durability
- Chisel, no rotation during use on working surface

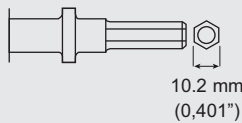

RP9312 Kit

with 5 hexagonal chisels
See details on page 40



RP9315

Heavy duty air hammer

FEATURES

- Aluminium body
- Round shank
- Most powerful hammer in its class
- Longer piston strokes for more force per blow

BENEFITS

- Withstands rugged
- Fast action & heavy duty
- Ideal tool for heavy duty

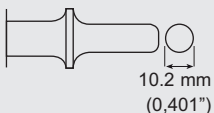

RP9538

2 tools in 1

FEATURES

- General purpose needle scaler
- Weld flux chipping hammer
- Quick change chisel retainer
- 19 x 3mm (1/8") steel needles and 35mm (1.37") width chisel with high resistance to wear

BENEFITS

- Easily convert from needle scaler to Chipping hammer and vice versa
- Durable and economical solution
- Ideal for surface preparation work
- Adjustable sleeve to fit the length of the needles to the task to be performed

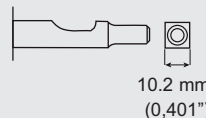

RP9538: supplied with needle 19 x 3mm (1/8") then 1/2" square Chisel

See accessories on pages 40/41

MODEL	PART NUMBER	COLD RIVET CAP. (DURAL)		COLD RIVET CAP. (STEEL)		BORE AND STROKE		BLOWS PER MIN.	CHISEL RIVET SET SHANK		AIR CONS.		OVERALL LENGTH		NET WEIGHT		NOISE LEVEL	SOUND POWER	VIBRATION	AIR INLET
		mm	in.	mm	in.	mm	in.		mm	in.	l/s	cfm	mm	in.	kg	lb				
RP9312	615 196 9312	6.4	1/4	4.8	3/16	19x67	3/4x2 ^{5/8}	3,000	10.2	0.401	11.8	25.0	171	6.7	1.6	3.5	100	111	8.9	1/4"
RP9312 KIT	615 196 0312	6.4	1/4	4.8	3/16	19x67	3/4x2 ^{5/8}	3,000	10.2	0.401	11.8	25.0	171	6.7	1.6	3.5	100	111	8.9	1/4"
RP9315	615 196 9315	7.9	5/16	6.4	1/4	19x89	3/4x3 ^{1/2}	2,300	10.2	0.401	11.8	25.0	225	8.9	1.9	4.2	100	111	9.4	1/4"
RP9538	615 196 9538					25x28.6	1x1 ^{1/8}	4,600		1/2 Sq.	7.4	15.5	457	18.0	2.8	6.2	99	110	9.7	1/4"

90 PSI(@6.3 Bar) - Listed specifications are for reference only. Please check documents in each tool.

Accessories

HAMMER KITS

RP9311 KIT - Round shank - Included:

- RP9311 Hammer (Qty 1)
- 178mm (7") chisels (5)
- Air nipple (1)
- Chisel retainer (1)
- Mini oiler (brasse) (1)

RP9312 KIT - Hex. shank - Included:

- RP9312 Hammer (Qty 1)
- 178mm (7") chisels (5)
- Air nipple (1)
- Chisel retainer (1)
- Mini oiler (brasse) (1)



HAMMER RETAINER

TOOLS		PART NUMBER
RP9536/RP9537 RP9311/RP9315/ RP9312	Retainer spring	205 048 826 3
	Retainer - Quick change	205 048 741 3



CHISELS

TOOLS		PART NUMBER
RP9538	Curved chisel 35mm (1.37") Qty. 1	205 049 965 3
RP9538	Pointed chisel Qty. 1	205 051 279 3
RP9538	Flat chisel 20mm (0.79") Qty. 1	205 051 280 3

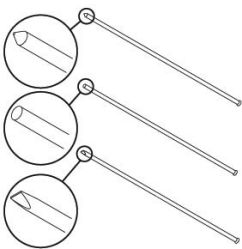

NEEDLES SETS

TOOLS		PART NUMBER
RP9538	Steel needles flat set, Ø 3mm (1/8") length 178mm (7") Qty. 19	P100146
RP9538	Stainless needles flat set, Ø 3mm (1/8") length 178mm (7") Qty. 19	P106454
RP9538	Needles set chisel tip, Ø 3mm (1/8") length 178mm (7") Qty. 100	615 399 819 0
RP9538	Needles set flat tip, Ø 3mm (1/8") length 178mm (7") Qty. 100	615 399 817 0
RP9538	Needles set pointed tip, Ø 3mm (1/8") length 178mm (7") Qty. 100	615 399 821 0

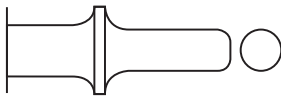
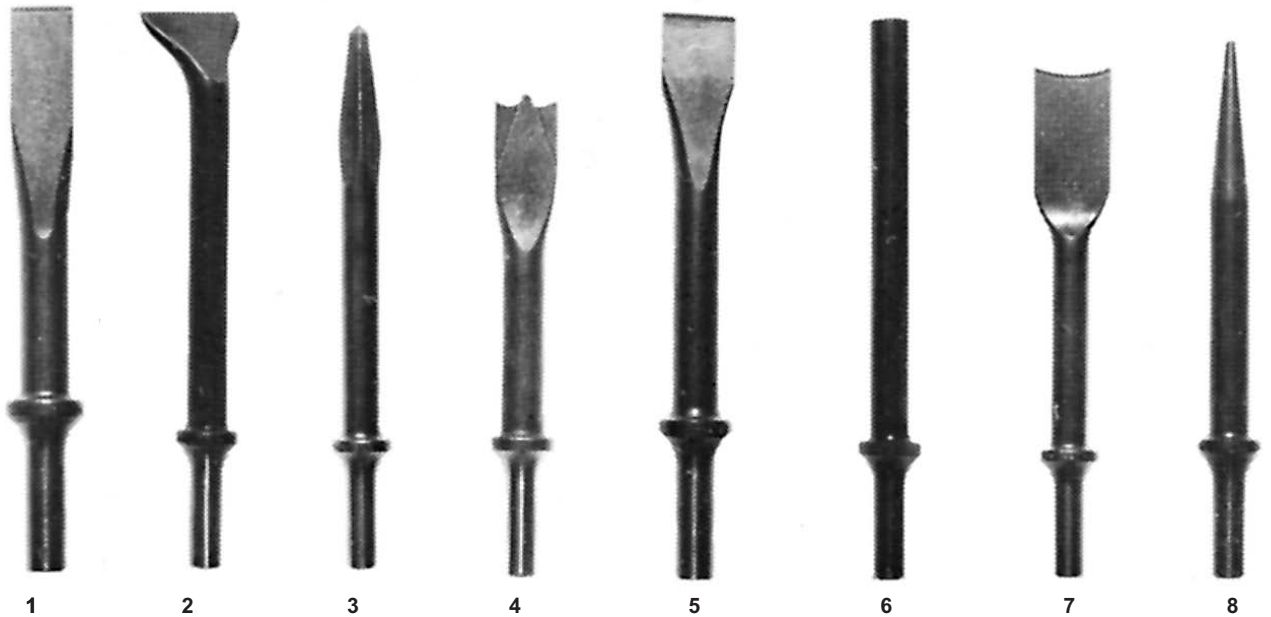

0.401" (10,2mm) - ROUND SHANK FOR HAMMERS RP9311/RP9315/RP9536/RP9537

INDEX N°	LENGTH			PART NUMBER
	mm	in.		
1	165	6.5	Rivet cutter	A046050
2	165	6.5	Angle scaling chisel	A046063
3	178	7.0	Diamond point chisel	A046064
4	178	7.0	Twin blade panel (pipe) cutter	A046071
5	178	7.0	Cold chisel	A046073
5	457	18.0	Cold chisel	A046080
6	178	7.0	Straight punch	A046074
7	178	7.0	Spot weld splitter	A046075
8	178	7.0	Tapered punch	A046078

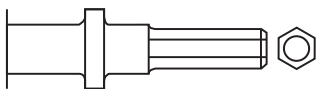

0.401" (10.2mm) HEXAGONAL SHANK FOR HAMMER RP9312

INDEX N°	LENGTH			PART NUMBER
	mm	in.		
1	165	6.5	Hex rivet cutter	CA155778
2	178	7.0	Hex angle scaling chisel	CA155780
3	178	7.0	Hex diamond point chisel	CA155782
4	165	6.5	Hex twin blade panel (pipe) cutter	CA155784
5	178	7.0	Hex cold chisel	CA155786
6	178	7.0	Hex straight punch	CA155790
7	178	7.0	Hex spot weld splitter	CA155792
8	178	7.0	Hex tapered punch	CA157107



RediPower

Speciality tools

RediPower

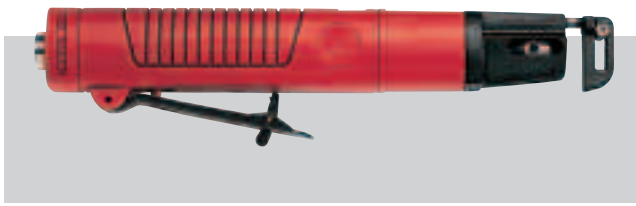

RP9881

Heavy Duty

FEATURES

- Heavy duty reciprocating saw
- Safety lever to reduce the risk of inadvertent starting
- Lock off lever throttle
- Adjustable guard guide

BENEFITS

- Ergonomic design for comfort and easy handling
- Low vibrations



ACCESSORIES	PART N°
14T Saw blade (1)	205 048 893 3
18T Saw blade (1)	205 048 894 3
24T Saw blade (1)	205 048 895 3
Hex. Wrench	205 048 899 3



RP9882

Heavy Duty

FEATURES

- High speed reciprocating saw
- Heavy duty construction for longer life
- Safety lever to reduce the risk of inadvertent starting
- Adjustable guard
- Handle rubber grip

BENEFITS

- Comfort operator
- Ideal tool for intensive use
- General cutting tool



ACCESSORIES	PART N°
18T Saw blades (5)	894 015 877 5
24T Saw blades (5)	894 015 877 6
32T Saw blades (5)	894 015 877 7

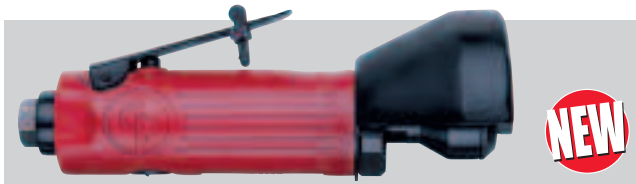

RP9884

High Speed Cutter

FEATURES

- Standard duty high speed cutter
- Wheel diameter 76mm (3")
- Safety lever to reduce the risk of inadvertent starting
- Adjustable speed
- Rear exhaust

Supplied with:
Package of
5 wheels
CA-155312
(3 x 1/16" x 3/8")

BENEFITS

- Precise control
- Ideal for cutting through composite, sheet metal, bolts, etc...



RP9160

Compact engraving pen

FEATURES

- Finger tip start valve
- Compact and lightweight tool
- Fine point stylus for easy operation

BENEFITS

- Easy handling and operation
- Operator comfort
- Enhanced control

Supplied with:
Engraving needle,
medium Qty. 1
205 048 954 3

MODEL	PART NUMBER	WHEEL DIAMETER		MAX. SPEED	BLOWS PER MIN.	STROKE		AIR CONS.		OVERALL LENGTH		NET WEIGHT		NOISE LEVEL	VIBRATION	AIR INLET
		mm	in.			rpm	mm	in.	l/s	cfm	mm	in.	kg			
RP9881	615 197 9881	-	-	-	5,000	25	1	13.0	27	268	10.5	1.0	2.20	81	<2.5	1/4"
RP9882	615 197 9882	-	-	-	9,500	10	3/8	2.8	6	219	8.63	0.74	1.63	97.7	12.9	1/4"
RP9884	615 197 9884	76	3	22,000	-	-	-	5.9	12.5	184	7.25	0.79	1.75	99	4.0	1/4"
RP9160	615 197 9160	-	-	-	32,400	-	-	0.8	1.69	147	5.8	0.123	0.25	59	<7.0	1/4"

@90 PSI(@6.3 Bar) - Listed specifications are for reference only. Please check documents in each tool.



Speciality tools



RP9840

Ergonomic and lightweight tool

FEATURES

- Ergonomic Air Riveter
- 3/16" (4.8mm) Max. capacity
- Designed Rivet Vacuum system
- Lightweight tool
- Rivet's shaft collector

BENEFITS

- Delivered with 3/32", 1/8", 5/32" and 3/16" (2.4, 3.2, 4 and 4.8mm) nose pieces
- Operator comfort and safety



RP9850

Large Blind Rivet dimensions

FEATURES

- Ergonomic Air Riveter
- 1/4" (6.4mm) Max. capacity
- Designed Rivet Vacuum system
- Lightweight tool
- Rubber handle grip
- Rivet's shaft collector

BENEFITS

- Delivered with 3/16", 7/32" and 1/4" (4.8, 5.6 and 6.4mm)
- Operator comfort and safety
- Easy accessories change



ACCESSORIES	PART No.
Spent mandrel bottle kit	205 051 801 3
Nose piece (4) 3/32", 1/8", 5/32", 3/16" (2.4, 3.2, 4, 4.8mm)	205 051 802 3

ACCESSORIES	PART No.
Spent mandrel bottle kit	205 051 801 3
Nose piece (3) 3/16", 7/32", 1/4" (4.8, 5.6, 6.4mm)	205 051 802 3



RP9880

Air Blow Gun

FEATURES

- Suspension Hook
- Progressive trigger action
- Angle nozzle
- 30 Psi max.

BENEFITS

- Ergonomic handle
- Easy access into confined areas

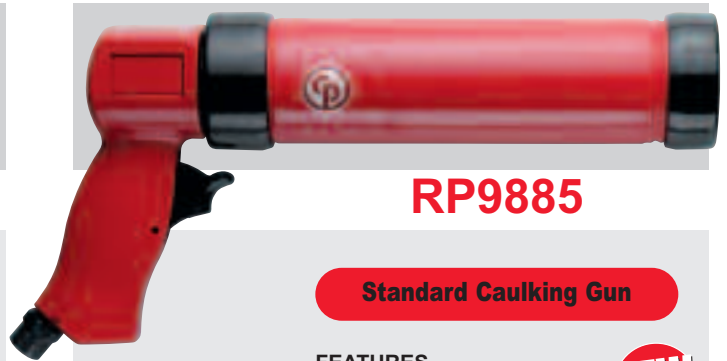

RP9885

Standard Caulking Gun

FEATURES

- Labour time saving body-caulk application tool
- No hand fatigue
- Trigger controlled material flow
- Accepts standard cartridges: 50 x 215mm (2" x 8-1/2")

BENEFITS

- Easy to handle
- Operator comfort



MODEL	PART NUMBER	MAX. AXIAL PULLING LOAD		MAX. STROKE		AIR CONS.		OVERALL LENGTH		NET WEIGHT		NOISE LEVEL	VIBRATION	AIR INLET
		kg	lb @85psi	mm	in.	l/s	cfm	mm	in.	kg	lb	dB(A)	m/s ²	NPTF
RP9840	615 197 9840	1089	2400	19.5	0.767	1.85	4.0	290	11.40	1.88	4.10	72	<2.5	1/4"
RP9850	615 197 9850	1679	3700	15.0	0.590	1.85	4.0	301	11.85	1.95	4.29	66	3.2	1/4"
RP9880	615 197 9880	-	-	-	-	10.54	22.0	245	10.00	0.13	0.29	95	-	1/4"
RP9885	615 197 9885	-	-	-	-	8.0	16.8	270	10.06	1.04	2.32	82	<2.5	1/4"

@90 PSI(@6.3 Bar) - Listed specifications are for reference only. Please check documents in each tool.

It is strongly recommended that you install a Filter, Regulator and Lubricator between the air supply and every air tool. By installing these accessories, the life of the air tool is greatly increased. The separator traps the moisture before it enters the air tool. The pressure regulator can be adjusted so that the correct air pressure enters the tool while high pressures are maintained at the compressor. The line lubricator allows the proper amount of lubrication needed for top performance.

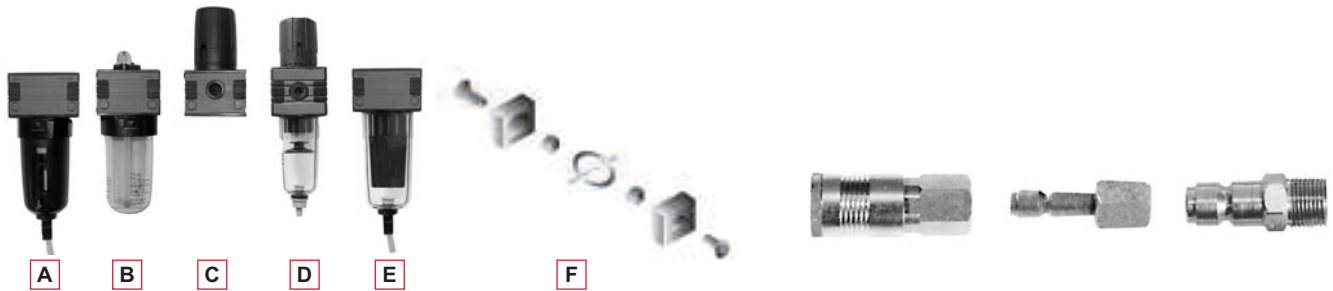

FILTER, REGULATOR & LUBRICATOR



MODEL	PORT SIZE	PART No.
A Filter, Semi-Auto Drain, Bowl Guard	G 1/2"	109182
B Oil Mist Lubricator	G 1/2"	109202
C Regulator	G 1/2"	109192
D Filter/Regulators, Semi-Auto Drain	G 1/2"	109232
D Filter/Regulators, Semi-Auto Drain, Bowl Guard	G 1/2"	109222
E Submicro-Filter Units, manual drain	G 1/2"	109282
F Coupling kit for connecting 2 single units	G 1/2"	109402

GREASE GUN

	AMOUNT	PART No.
 3 Ounce Capacity Uses Molybased Clutch Grease	413cc (14oz)	894 015 845 6

C098689

AIR FLOW REGULATORS

	<p>ECONOMY FLOW REGULATOR</p> <p>Attaches to all air tools with 1/4" NPTF air inlet thread size.</p> <p>Provides quick regulation of air flow.</p> <p style="text-align: right;">LC-121737</p>
	<p>HEAVY-DUTY FLOW REGULATOR</p> <p>Very fine control over entire range.</p> <p>Corrosion resistant bronze construction 1/4" NPTF.</p> <p>Positive jaw lock prevents vibration induced.</p> <p style="text-align: right;">CA-085203</p>

QUICK-CHANGE COUPLERS

NOTE:

Numbers in parentheses indicate mfg. identification stamped on couplers.

COUPLER SIZE	CFM*	THREAD SIZE In.	COUPLER BODY FPT	NIPPLE FPT	NIPPLE MPT
6	31	1/4"	CA-046300 (13)	CA-046301 (3c)	CA-046302 (2c)
9	70	1/4"	CA-047300 (15c)	CA-047302 (1e)	CA-047303 (0e)
9	70	3/8"	CA-047301 (15)	CA-047304 (3e)	CA-047305 (2e)
12.5	125	3/8"	CA-049300 (17e)	CA-049302 (1f)	CA-049303 (0f)
12.5	125	1/2"	CA-049301 (17)	CA-049304 (3f)	CA-049305 (2f)

*Recommended working CFM - 30% of maximum flow (ASME power test)



HOSE WHIPS MALE ENDS

Always use a hose whip between the tool and the air supply hose.

It provides safety and longer tool air inlet life.

HOSE DIA. in.	THREAD SIZE In.	HOSE LGTH. cm (ft.)	PART NUMBER
6	1/4	183 (6)	CA-046270
9	1/4	61 (2)	CA-047270
9	3/8	183 (6)	CA-047271
12.5	3/8	91.5 (3)	CA-049271
12.5	1/2	61 (2)	CA-049270

GREASE

AIROILENE OIL		PNEU-LUBE CLUTCH GREASE		PROTECTO-LUBE	
High refined oil for use in lean tools. Use in air line lubricators and in integral oil reservoirs provided on some tools.		Synthetic grease specially formulated to extend the life of your impact wrench clutches.		Cleans out gum and deposits in air tools.	
AMOUNT	PART No.	AMOUNT	PART No.	AMOUNT	PART No.
3.8l (1gal)	P089507	103cc (3.5oz.) 7 lb.	894 015 845 5 894 015 845 7	591cc (20oz.) 118cc (4oz.)	CA000046 CA149661



Tune-up kits & repair kits



MODEL	TUNE-UP KIT	BEVEL GEAR	REPAIR KIT	RATCHET HEAD REPLACEMENT	REGULATOR ASSEMBLY	NOISE REDUCER
RP2031	894 020 840 4					
RP2036	894 020 840 5					
RP2037	894 020 840 1					
RP2041	894 020 840 2					
RP2042	894 020 840 6					
RP2755	205 050 777 3					
RP2765	205 050 780 3					
RP9104Q	205 050 662 3					
RP9105	205 050 670 3					
RP9106	205 050 674 3					
RP9107	205 050 668 3					
RP9108	205 050 676 3					
RP9110	205 050 660 3					
RP9111 (SERIE D ->...)	205 050 678 3					205 051 649 3
RP9112Q (SERIE D ->...)	205 050 680 3					205 051 649 3
RP9120	205 050 482 3	205 050 483 3				
RP9121	205 050 482 3	205 050 483 3				
RP9122	205 050 482 3	205 050 483 3				
RP9123	205 050 373 3	205 050 441 3				
RP9160	205 050 691 3					
RP9164	205 050 672 3					
RP9280	205 050 646 3					
RP9285	205 050 374 3					205 051 649 3
RP9286	205 050 375 3					205 051 649 3
RP9287	205 050 374 3					205 051 649 3
RP9288	205 050 375 3					205 051 649 3
RP9289						205 051 649 3
RP9311	205 050 682 3					
RP9312	205 050 682 3					
RP9315	205 050 686 3					
RP9425	894 015 889 3			KF141880		
RP9429	894 015 888 5			894 015 888 6		
RP9430	894 015 888 5			894 015 888 7		
RP9431Q	894 015 902 4		894 015 903 5	894 015 861 3		
RP9432Q	894 015 902 4		894 015 903 6	894 015 861 4		
RP9521	894 016 308 3				CA127951	
RP9522	C146210					
RP9523	894 016 308 3				CA127951	
RP9524	CA157814		CA157815			
RP9525	CA157814		CA157524			
RP9526	CA157814		CA157816			
RP9527	CA157814		CA157525			
RP9536	205 050 508 3					
RP9537	205 050 509 3					
RP9538	205 050 693 3					
RP9539	205 050 693 3					
RP9540	CA157792		CA157793			
RP9541	C137164		C137478			
RP9542	C137164		C137165			
RP9543	C137164					
RP9545	894 015 903 7		894 0159 038			
RP9546	894 015 863 5		894 0158 636			
RP9547	C157526		C157527			
RP9548	C157526		C157529			
RP9549	C157526		C157528			
RP9560	CA157799		CA157800			
RP9561	C137569		CA157719			
RP9582	CA157827		CA157826			
RP9583	CA157827		CA157826			
RP9597	CA126992					
RP9776	205 050 668 3					
RP9778	205 050 666 3					
RP9779	205 050 385 3					
RP9780	205 050 386 3					
RP9789	205 050 656 3					
RP9790	205 050 654 3					205 051 649 3
RP9791	205 050 656 3					205 051 649 3
RP9792	205 050 654 3					205 051 649 3
RP9840	205 051 799 3					
RP9850	205 051 800 3					
RP9879	205 050 652 3					205 051 290 3
RP9881	205 050 507 3					
RP9887	205 050 650 3					205 051 290 3

MODEL	PART N°	DESCRIPTION	PAGE
RP1064	615 194 1064	Drill	18
RP1264	615 194 1264	Drill	18
RP1274	615 194 1274	Drill	19
RP1454	615 194 1454	Drill	18
RP1664	615 194 1664	Drill	18
RP2003	615 192 2003	Screwdriver	15
RP2005	615 192 2005	Screwdriver	14
RP2006	615 192 2006	Screwdriver	14
RP2007	615 192 2007	Screwdriver	15
RP2008	615 192 2008	Screwdriver	14
RP2009	615 192 2009	Screwdriver	14
RP2010	615 192 2010	Screwdriver	15
RP2011	615 192 2011	Screwdriver	14
RP2012	615 192 2012	Screwdriver	14
RP2014	615 192 2014	Screwdriver	14
RP2015	615 192 2015	Screwdriver	14
RP2036	615 192 2036	Screwdriver	13
RP2037	615 192 2037	Screwdriver	13
RP2041	615 192 2041	Screwdriver	13
RP2042	615 192 2042	Screwdriver	13
RP2754	615 192 2754	Screwdriver	12
RP2755	615 192 2755	Screwdriver	12
RP2764	615 192 2764	Screwdriver	12
RP2765	615 192 2765	Screwdriver	12
RP2780	615 192 2780	Screwdriver	12
RP9101	615 195 9101	Grinder	26
RP9102	615 195 9102	Grinder	26
RP9104Q	615 195 9104	Grinder	24
RP9104Q KIT	615 195 0104	Grinder	24
RP9105	615 195 9105	Grinder	24
RP9106	615 195 9106	Grinder	24
RP9107	615 195 9107	Grinder	25
RP9107 IKIT	615 194 8107	Grinder	25
RP9107 MKIT	615 154 0107	Grinder	25
RP9108	615 195 9108	Grinder	24
RP9110	615 195 9110	Grinder	25
RP9111	615 195 9111	Grinder	25
RP9111Q IKIT	615 195 8111	Grinder	25
RP9111Q MKIT	615 195 0111	Grinder	25
RP9112Q	615 195 9112	Grinder	25
RP9113	615 195 9113	Grinder	26
RP9114	615 195 9114	Grinder	26
RP9118	615 195 9118	Grinder	27
RP9120	615 195 9120	Grinder	27
RP9121	615 195 9121	Grinder	27
RP9122	615 195 9122	Grinder	27
RP9123	615 195 9123	Grinder	27
RP9160	615 197 9160	Engraving pen	43
RP9164	615 193 9164	Sander	32
RP9280	615 194 9280	Drill	19
RP9285	615 194 9285	Drill	20
RP9286	615 194 9286	Drill	20
RP9287	615 194 9287	Drill	20
RP9288	615 194 9288	Drill	20
RP9311	615 196 9311	Hammer	38
RP9311 KIT	615 196 0311	Hammer	38
RP9312	615 196 9312	Hammer	39
RP9312 KIT	615 196 0312	Hammer	39
RP9315	615 196 9315	Hammer	39
RP9425	615 190 9425	Ratchet Wrench 1/4	8

MODEL	PART N°	DESCRIPTION	PAGE
RP9429	615 190 9429	Ratchet Wrench 3/8"	8
RP9430	615 190 9430	Ratchet Wrench 1/2"	8
RP9431Q	615 190 9431	Ratchet Wrench 3/8"	8
RP9432Q	615 190 9432	Ratchet Wrench 1/2"	8
RP9521	615 190 9521	Impact Wrench 3/8"	4
RP9522	615 190 9522	Impact Wrench 3/8"	4
RP9523	615 190 9523	Impact Wrench 3/8"	4
RP9524	615 190 9524	Impact Wrench 3/8"	4
RP9525	615 190 9525	Impact Wrench 3/8"	4
RP9526	615 190 9526	Impact Wrench 1/2"	5
RP9527	615 190 9527	Impact Wrench 1/2"	5
RP9534	615 193 9534	Sander	32
RP9536	615 196 9536	Hammer	38
RP9537	615 196 9537	Hammer	38
RP9538	615 196 9538	Hammer	39
RP9540	615 190 9540	Impact Wrench 1/2"	5
RP9541	615 190 9541	Impact Wrench 1/2"	5
RP9542	615 190 9542	Impact Wrench 1/2"	5
RP9543	615 190 9543	Impact Wrench 7/16" Hex.	5
RP9545	615 190 9545	Impact Wrench 1/2"	5
RP9546	615 190 9546	Impact Wrench 1/2"	6
RP9546 IKIT	615 190 8546	Impact Wrench 1/2"	6
RP9546 MKIT	615 190 0546	Impact Wrench 1/2"	6
RP9547	615 190 9547	Impact Wrench 3/4"	6
RP9548	615 190 9548	Impact Wrench 1"	7
RP9549	615 190 9549	Impact Wrench 3/4"	6
RP9550 IKIT	615 190 9550	Impact Wrench 1/2"	5
RP9551 IKIT	615 190 9551	Impact Wrench 3/4"	6
RP9552 MKIT	615 190 9552	Impact Wrench 1/2"	5
RP9553 MKIT	615 190 9553	Impact Wrench 3/4"	6
RP9560	615 190 9560	Impact Wrench 3/4"	6
RP9561	615 190 9561	Impact Wrench 3/4"	6
RP9582	615 190 9582	Impact Wrench 1"	7
RP9583	615 190 9583	Impact Wrench 1"	7
RP9597	615 190 9597	Impact Wrench 1"	7
RP9674	615 193 9674	Sander	32
RP9775	615 193 9775	Sander	33
RP9775 KIT	615 193 0775	Sander	33
RP9776	615 193 9776	Sander	33
RP9776 KIT	615 193 0776	Sander	33
RP9777	615 193 9777	Sander	33
RP9777 KIT	615 193 0777	Sander	33
RP9778	615 193 9778	Sander	32
RP9779	615 193 9779	Sander	34
RP9780	615 193 9780	Sander	34
RP9789	615 194 9789	Drill	20
RP9790	615 194 9790	Drill	20
RP9790 IKIT	615 194 8790	Drill	20
RP9790 MKIT	615 194 0790	Drill	20
RP9791	615 194 9791	Drill	20
RP9792	615 194 9792	Drill	20
RP9840	615 197 9840	Air hydraulic riveter	44
RP9850	615 197 9850	Air hydraulic riveter	44
RP9879	615 194 9879	Drill	19
RP9880	615 197 9880	Blow gun	44
RP9881	615 197 9881	Saw	43
RP9882	615 197 9882	Saw	43
RP9884	615 197 9884	Cut Off tool	43
RP9885	615 197 9885	Caulking gun	44
RP9887	615 194 9887	Drill	19

Conversions to International Measurements

CONVERSION FACTORS			POWER		AIR PRESSURE		SOUND LEVEL
LENGTH			1 kpm/s	9.8067 W	1 bar	100 kPa	
1 Inch (in.)	0.0254 m	25.4 mm	1 hp	745.7 W	1 kp/cm ² (at)	98.0665 kPa	
1 Foot (ft.)	0.3048 m	304.8 mm	1 kW	1.3410 hp	1 psi	6.8948 kPa	
WEIGHT			TORQUE		AIR FLOW		
1 Ounce (oz.)	0.02835 kg	28.35 g	1 kpm	9.8067 Nm	1 m ³ /min	16.6667 l/s	
1 Pound (lb.)	0.454 kg	454 g	1 Ft lb	1.3558 Nm	1 cfm	0.4720 l/s	
1 kg	2.2046 lb		1 In lb	0.1130 Nm	1 m ³ /h	0.2778 l/s	
VOLUME			1 Nm	0.1020 kpm	1 l/s	2.1189 cfm	
1 US Gallon	3.785 l		1 Nm	0.7376 ft lb			

Expressed in dB(A). This is the pressure measurement according to method outline in ISO regulation ISO-15744.

Safety instructions

General Safety Instructions for the Operation of Power Tools

The goal of is to produce tools that help the operator work safely and efficiently.

The most important safety device for this or any other tool is the operator. Care and good judgement are the best protection against injury.

All possible hazards cannot be covered here, but we have tried to highlight some of the important ones.

Individuals should look for and obey Caution, Warning and Danger signs placed on tools, and displayed in the workplace. Operators should read and follow safety instructions packed with each tool. For a copy of these instructions, contact your local representative.

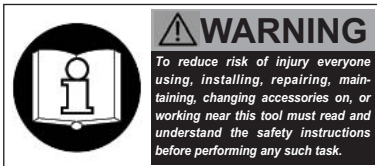

Learn how each tool works. Even if you have previously used similar tools, carefully check out each tool before you use it. Get the 'feel' of it and know its capabilities, limitations, potential hazards, how it operates and how it stops.

All tools are designed to operate at a line pressure of 6.3 bar +/- 0.15bar in accordance with ISO2787.

Sound levels +/- 3dB(A)* measured in accordance with EN ISO15744. Vibration values* measured in accordance with ISO 8662.

*These declared values were obtained by laboratory testing in compliance with stated standards and are not adequate for risk assessments. Values measured in individual work places may be higher than the declared values. The actual exposure values and risk of harm experienced by an individual are unique and depend upon the way the user works, the workplace and the work station design, as well as upon the exposure time and the physical condition of the user. We cannot be held liable for the consequences of using declared values, instead of values reflecting the actual exposure, in an individual risk assessment in a work place situation over which we have no control.

Tools are CE marked to comply with European Machinery Directive.

Specifications subject to change without prior notice.

Further occupational health and safety information can be obtained from the following web sites:

<http://www.osha.gov> (USA)

<http://europe.osha.eu.int> (Europe).



COMPRESSED AIR HAZARDS

- Air under pressure can cause injury. Never point an air hose at yourself or anyone else. Never blow your clothes free of dust with compressed air. Always direct exhaust air away from yourself and others in the work area.
- Always check for damaged or loose hoses and fittings before using an air tool, and replace if necessary. Whipping hoses can cause serious injury.
- Disconnect the tool from the air supply when not in use, before changing accessories, setting the torque, or when making repairs.
- Do not exceed rated air pressure to increase the output of the tool. This could cause injury and shorten tool life.
- Do not assemble quick coupler on the tool. Vibration can cause breakage resulting in a whipping air hose. Instead, use quick couplers on the end of a short leader hose.
- When universal twist couplings are used, lock pins must be installed to prevent accidental hose disconnection.
- Air tools are not intended for use in explosive atmospheres and are not insulated for contact with electric power sources.



ELECTRICAL HAZARDS

- Power tool plugs must match the outlet. Never modify the plug in any way. Do not use any adapter plugs with earthed (grounded) power tools and equipment. Unmodified plugs and matching outlets will reduce risk of electric shock.
- Avoid body contact with earthed or grounded metal surfaces. There is an increased risk of electric shock if your body is earthed or grounded.
- Do not abuse the cord. Never use the cord for carrying, pulling or unplugging the power tool. Keep cord away from heat, oil, sharp edges or moving parts. Damaged or entangled cords increase the risk of electric shock.
- Do not expose electric power tools and equipment to wet conditions.
- Do not operate power tools in explosive atmospheres. Power tools create sparks which may ignite dust, fumes or flammable liquids.
- Have electric power tools and equipment serviced by a qualified repair person using only identical replacement parts.



PROJECTILE HAZARDS

- Always wear impact resistant eye and face protection when involved with or near the operation or repair of tools.



BREATHING HAZARDS

- Proper breathing protection must be worn when working with materials, which produce airborne particles.



NOISE HAZARDS

- Hearing loss can result from prolonged exposure to excessive sound levels.
- Use hearing protection as recommended by your employer or Occupational Health and Safety Regulations.



VIBRATION HAZARDS

- Repetitive work motions, awkward positions, and exposure to vibration may be harmful to your hands and arms.
- If numbness, tingling, pain or whitening of the skin occurs, stop using tool and consult a physician.



ENTANGLEMENT HAZARDS

- To reduce the risk of injury from entanglement, do not wear loose clothing when using rotating accessories.



ADDITIONAL HAZARDS

- Slip/Trip/Fall is a major cause of serious injury or death. Beware of excessive hose/cord left on the walking or work surface.
- Operators and maintenance personnel must be physically fit to perform job tasks, and handle the bulk, weight and power of the tool.
- Deburring tools should be used to reduce the risk of cuts and abrasions due to burrs.
- Wear gloves to protect hands from sharp edges.

Specific Safety Instructions for Power Tool Groups

In addition to the General Safety Instructions, the following are safety instructions and warnings that apply to the safe operation of specific power tool groups.



COMPRESSION TOOLS

- To reduce the risk of injury always keep hands and fingers away from yoke and moving jaws, sets or dies. If possible, hold the tool body with both hands.
- Inspect the yoke daily for cracks. Injury may result if a cracked yoke fails during use.
- All yokes have a life limitation based on cycles and riveting force. This tool and its accessories must not be modified.



DRILLS & TAPPERS

- Keep away from rotating bit and chuck. You can become cut or burned if you come into contact with the drill bit or tap, chips/swarf, or work surface.
- Use intermittent drill feed pressure to avoid long shaved chips/swarf.
- The drill bit or tap can suddenly bind and cause the workpiece or tool to rotate, causing arm and shoulder injuries.
- It is recommended that side handles are used for operator comfort and safety on high torque drilling applications above 4Nm (3 lbft) on straight case tools and 10Nm (7.4 lbft) on pistol grip drills. Drills with a chuck capacity larger than 10mm (3/8") should always be used with a side handle.



PERCUSSIVE TOOLS (Riveting Hammers, Air Scribe)

- All chisels, rivet sets and other associated accessories should be checked for cracks, excessive wear, or other physical damage before each use. Accessories that show signs of damage should be replaced immediately.
- Never use a tool without the proper accessory retainer.



IMPACT AND IMPULSE WRENCHES

- Never use hand sockets or accessories. Use only impact sockets and accessories in good condition. Sockets in poor condition reduce impact power and could also shatter, resulting in personal injury.
- When using a universal joint, never operate the tool off the work. It may run too fast and cause the joint to be thrown from the tool.
- Always use the simplest hook up possible. Long springy extension bars and adapters absorb impact power and could break loose resulting in personal injury. Instead, use deep sockets wherever possible.
- For tools using the pin and o-ring socket retainer, use the o-ring to securely retain the socket pin or use a one-piece retainer ring to retain the socket.
- Serious injury can result from overtorqued or under-torqued fasteners, which can break, or loosen and separate. Released assemblies can become projectiles. Assemblies requiring a specific torque must be checked using a torque meter.

NOTE: So-called 'click' torque wrenches do not check for potentially dangerous over-torqued conditions.



ANGLE WRENCHES

- Never use hand sockets or accessories. Use only power drive sockets and accessories.
- To reduce the risk of injury, always support the handle securely in the direction opposite of the spindle rotation to minimize torque reaction.



ACCESSORIES

- Always use accessories of correct size and design for the tool. Tool and accessories must not be modified in any way.
- Never use a tool without the proper accessory retainer.
- Do not use a tool or attachment for a purpose not intended by the manufacturer.



OTHER TOOLS (e.g. Screwdrivers, Shears, Saws, etc.)

- Specific instructions/warnings affecting this group of tools are contained in product-specific documents accompanying each product.



ABRASIVE TOOLS

- Before grinding, test grinding wheel by briefly running tool at full throttle. Be sure to use a barrier (such as under a heavy work table) to protect yourself from possible broken wheel parts.
- Never mount a grinding wheel on a sander.
- Never use a grinding wheel rated at a speed lower than the air grinder speed.
- All grinding wheels and polishing/sanding accessories should be checked for cracks or other damage before mounting and use.
- Always use the recommended wheel guard to prevent injury when performing grinding operations. If a guard has withstood wheel or disk breakage, it must be replaced.
- Position a guard between the grinding wheel or disc and the operator.
- Use barriers to protect others from fragments and grinding sparks.
- Make sure grinding wheels are mounted according manufacturer's specifications: always use correct mounting flanges.
- Never tamper with or remove a speed governor from a tool to make it run faster. Periodically check tool speed with a tachometer.



For more information about ergonomics please ask for the CP Ergosense booklet LT198 or visit www.cp.com

www.cp.com



Please find your local contact at: www.cp.com



Chicago
Pneumatic

Desoutter

**GEORGES
RENAULT**

SCANROTOR

techmotive

RediPower

